

NOTICE!!

These documents have been scanned!

Do not place un-scanned documents beneath this notice!

Do not remove this notice from this file!

GPO Jacket No. 560-102
Print Order 61540
Rise Business Services, LLC
Job=AZ15 5/13/2019



Box Number= AZ15043



Claim Begin-End: AMC418628-AMC418628

1 Initial Receipt



AZ15043-1

AMC418628-AMC420131

United States Department of the Interior
Bureau of Land Management
 LANDS/RECREATION & PLANNING
 ONE N CENTRAL AVE
 PHOENIX, AZ 85004 -2203
 Phone: 602-417-9200

Receipt

No: 2682678

Transaction #: 2764164		ENTERED INTO COMPUTER
Date of Transaction: 11/01/2012		
CUSTOMER:		NOV 29 2012 <i>ps</i>
GARY L HALEY PO BOX 584 GREEN VALLEY, AZ 85622-0584 US		

LINE #	QTY	DESCRIPTION	REMARKS	UNIT PRICE	TOTAL
1	1.00	LOCATABLE MINERALS / MINING CLAIMS- NEW, UNADJUD, ONE OR MORE AUTH NOS / NEW MINING CLAIM LOCATION FEE \$34 CASES: AMC418628/\$34.00		- n/a -	34.00
2	1.00	LOCATABLE MINERALS / MINING CLAIMS- NEW, UNADJUD, ONE OR MORE AUTH NOS / NEW MINING CLAIM MAINT FEE \$140 CASES: AMC418628/\$140.00		- n/a -	140.00
3	1.00	LOCATABLE MINERALS / MINING CLAIMS- NEW, UNADJUD, ONE OR MORE AUTH NOS / NEW MINING CLAIM PROCESSING FEE \$15 CASES: AMC418628/\$15.00		- n/a -	15.00
TOTAL:					\$189.00

PAYMENT INFORMATION			
1	AMOUNT:	189.00	POSTMARKED: 10/30/2012
	TYPE:	CHECK	RECEIVED: 11/01/2012
	CHECK NO:	514	
	NAME:	HALEY, CONNIE L PO BOX 584 GREEN VALLEY AZ 85622-0584 US	

REMARKS

This receipt was generated by the automated BLM Collections and Billing System and is a paper representation of a portion of the official electronic record contained therein.

NOTICE!!

These documents have been scanned!

Do not place un-scanned documents beneath this notice!

Do not remove this notice from this file!

GPO Jacket No. 560-102
Print Order 61540
Rise Business Services, LLC
Job=AZ15 5/13/2019



Box Number= AZ15043



Claim Begin-End: AMC418628-AMC418628

2 Correspondence



AZ15043-1

AMC418628-AMC420131



United States Department of the Interior

BUREAU OF LAND MANAGEMENT

Arizona State Office

One North Central Avenue, Suite 800

Phoenix, Arizona 85004-4427

www.blm.gov/az/



OCT 30 2014

In Reply Refer To:

3800 (9310) RM

AMC418628, AMC421116, AMC421122,
AMC423063, AMC423064, AMC423704

CERTIFIED MAIL - RETURN RECEIPT REQUESTED No. 7014 0150 0000 5453 3086

NOTICE

GARY AND CONNIE HALEY

PO BOX 584

GREEN VALLEY, AZ 85622-0584

:
:
:

This Notice Affects Those Claims
Shown in the Block Below.

AMC418628, AMC421116, AMC421122, AMC423063, AMC423064, AMC423704
PEACHIE, APACHE MOON, BUZZARDS END, HONEYCOMB, APACHE MOON 2,
SKID MARK

Affidavit of Performance of Annual Work or Notice of Intent to Hold Discrepancies

We have received your Affidavit of Performance of Annual Work (POL) or Notice of Intent to Hold (NOI) for the 2014 assessment year for the mining claims listed above. However, there was a discrepancy as noted below:

We received the POL document and processing fee. You also filed an incomplete NOI. We did not receive page 1 of the NOI nor the processing fee for the NOI. The processing fee for a NOI is \$10 per claim. In accordance with Title 43 Code of Federal Regulations (CFR) 3830.91(8) you are allowed 30 days from the date you receive this Notice (or December 30, 2014, whichever is later) to pay the additional fees. If we do not receive your payment and completed NOI within this time frame, your documents will not be recorded by BLM and your mining claims will be closed. Any non-refundable processing fees already paid will be forfeited. The NOI is the document that is required to be filed the first year you are filing a waiver. Enclosed is a NOI form for your use.

Please correct the discrepancy and submit the requested documents or fee within 30 days from your receipt of this letter. If we do not receive the correct documents or processing fee within this 30-day time frame the claims will be declared forfeited.

FILED COMPLETED
NOI 11/17/2014. RM

SENDER: COMPLETE THIS SECTION

- Complete items 1, 2, and 3. Also complete item 4 if Restricted Delivery is desired.
- Print your name and address on the reverse so that we can return the card to you.
- Attach this card to the back of the mailpiece, or on the front if space permits.

1. Article Addressed to:

GARY AND CONNIE HALEY
PO BOX 584
GREEN VALLEY, AZ 85622-0584

423063 / 423064 / 423704

AZ 931 / RM / 418628 / 421116 / 421122

2. Article Number

(Transfer from service label)

7014 0150 0000 5453 3086

PS Form 3811, July 2013

Domestic Return Receipt

COMPLETE THIS SECTION ON DELIVERY

A. Signature

X

Gary Haley

☐ Agent

☐ Addressee

B. Received by (Printed Name)

Gary Haley

C. Date of Delivery

11-12-14

D. Is delivery address different from item 1?

☐ Yes

If YES, enter delivery address below:

☐ No

2014 NOV 13 P 2:17

PHOENIX, ARIZONA

3. Service Type

☒

Certified Mail®

☐

Priority Mail Express™

☐

Registered

☐

Return Receipt for Merchandise

☐

Insured Mail

☐

Collect on Delivery

4. Restricted Delivery? (Extra Fee)

☐ Yes

UNITED STATES POSTAL SERVICE

AZ 852

12 NOV '14

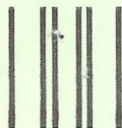

First-Class Mail
Postage & Fees Paid
USPS
Permit No. G-10

PN 91

- Sender: Please print your name, address, and ZIP+4® in this box•

U.S. DEPARTMENT OF THE INTERIOR
BUREAU OF LAND MANAGEMENT
ARIZONA STATE OFFICE
ONE NORTH CENTRAL AVENUE, SUITE 800
PHOENIX, AZ 85004-4427

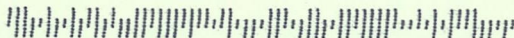

If additional information is required, please contact RéAnn Myers at 602-417-9413. Please include your AMC serial number(s) on all correspondence.

Sincerely,

A handwritten signature in cursive script that reads "Rebecca Heick".

Rebecca Heick
Acting Deputy State Director
Lands and Minerals Division

Enclosure

NOTICE!!

These documents have been scanned!

Do not place un-scanned documents beneath this notice!

Do not remove this notice from this file!

GPO Jacket No. 560-102
Print Order 61540
Rise Business Services, LLC
Job=AZ15 5/13/2019



Box Number= AZ15043



Claim Begin-End: AMC418628-AMC418628

3 Transfers



AZ15043-1

AMC418628-AMC420131

**NO
DOCUMENTS
FOUND**

NO DOCUMENTS FOUND
NO DOCUMENTS FOUND

NOTICE!!

These documents have been scanned!

Do not place un-scanned documents beneath this notice!

Do not remove this notice from this file!

GPO Jacket No. 560-102
Print Order 61540
Rise Business Services, LLC
Job=AZ15 5/13/2019



Box Number= AZ15043



Claim Begin-End: AMC418628-AMC418628

4 Miscellaneous



AZ15043-1

AMC418628-AMC420131

**NO
DOCUMENTS
FOUND**

NO DOCUMENTS FOUND
NO DOCUMENTS FOUND

NOTICE!!

These documents have been scanned!

Do not place un-scanned documents beneath this notice!

Do not remove this notice from this file!

GPO Jacket No. 560-102
Print Order 61540
Rise Business Services, LLC
Job=AZ15 5/13/2019



Box Number= AZ15043



Claim Begin-End: AMC418628-AMC418628

5 Annual Filings



AZ15043-1

AMC418628-AMC420131

UNITED STATES
DEPARTMENT OF THE INTERIOR
BUREAU OF LAND MANAGEMENT
MAINTENANCE FEE WAIVER CERTIFICATION

SEE INSTRUCTIONS ON PAGE 2

FORM APPROVED
OMB NO. 1004-0114
Expires: January 31, 2020

418628
421122
421116
423064
423063
423704

1. This small miner waiver is filed for the assessment year beginning on September 1, 2018 and ending on September 1, 2019
2. The undersigned and all related parties owned ten or fewer mining claims, mill, or tunnel sites located and maintained on Federal lands in the United States of America on September 1, 2019.
3. The undersigned have performed the assessment work required by law for each mining claim listed prior to filing this waiver and understand that by filing this form, the undersigned must file an affidavit of assessment work with the Bureau of Land Management (BLM) by the December 30th following the filing of this waiver.
4. The undersigned understand that if the assessment work obligation has not yet come due under 30 U.S.C. 28 (for those claims in their first assessment year only), a notice of intent to hold reciting this condition must be recorded by the December 30th following the filing of this waiver.
5. The undersigned understand that mill and tunnel sites may also be listed on this waiver and be waived from payment of the maintenance fee, and that a notice of intent to hold for these sites is required to be filed with the BLM by the December 30th following the filing of this waiver.
6. The undersigned understand and acknowledge that pursuant to 43 U.S.C. 1212 and 18 U.S.C. 1001, the filing or recording of a false, fictitious, or fraudulent document with the BLM may result in a fine of up to \$250,000, a prison term not to exceed five years, or both.
7. The mining claims, mill or tunnel sites for which this waiver from payment of the maintenance fees is requested are

CLAIM OR SITE NAME	BLM RECORDATION SERIAL NUMBER
1. PEACHIE	418628
2. BUZZARDS END	421122
3. APACHE MOON	421116
4. APACHE MOON 2	423064
5. HONEYCOMB	423063
6. SKID MARK	423704
7.	
8.	
9.	
10.	

RECEIVED
BLM AZ STATE OFFICE
2019 AUG 22 P 2:15
PHOENIX, ARIZONA

The owner(s) (claimants) of the above mining claims and sites are:

Connie Haley

(Owner's Name - Please Print)

PO Box 584, Green Valley, AZ 85622

(Owner's Mailing Address)

X *Connie Haley*

(Owner's Signature)

Green Valley

(City)

AZ

(State)

85622

(Zip Code)

Gary Haley

(Owner's Name - Please Print)

PO Box 584, Green Valley, AZ 85622

(Owner's Mailing Address)

X *Gary Haley*

(Owner's Signature)

Green Valley

(City)

AZ

(State)

85622

(Zip Code)

(Owner's Name - Please Print)

(Owner's Signature)

(Owner's Mailing Address)

(City)

(State)

(Zip Code)

(Owner's Name - Please Print)

(Owner's Signature)

(Owner's Mailing Address)

(City)

(State)

(Zip Code)

(Continued on page 2)

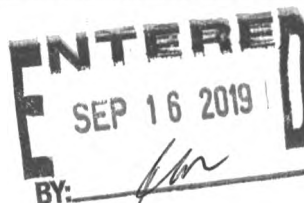

4541367

Gary Haley
Phone: (520) 648-2040

[Signature]

Connie Haley

(Owner's Name - Please Print)

X *Connie Haley*

(Owner's Signature)

PO Box 584

(Owner's Mailing Address)

Green Valley

(City)

AZ

(State)

85622

(Zip Code)

Gary Haley

(Owner's Name - Please Print)

X *Gary Haley*

(Owner's Signature)

PO Box 584

(Owner's Mailing Address)

Green Valley

(City)

AZ

(State)

85622

(Zip Code)

(Owner's Name - Please Print)

(Owner's Signature)

(Owner's Mailing Address)

(City)

(State)

(Zip Code)

(Owner's Name - Please Print)

(Owner's Signature)

(Owner's Mailing Address)

(City)

(State)

(Zip Code)

18 U.S.C. 1001 and 43 U.S.C. 1212 make it a crime for any person knowingly and willfully to make to any department or agency of the United States any false, fictitious or fraudulent statements or representations as to any matter within its jurisdiction.

INSTRUCTIONS

- 1 This certification is made under the provisions of 43 U.S.C. § 1744 and 30 U.S.C. § 28-28k and the regulations thereunder (43 CFR Part 3830).
- 2 The claimant(s) must fill in the dates in paragraph 1 for the beginning and ending of the assessment year for which this waiver is sought.
- 3 The claimant(s) must fill in the date in paragraph 2 for the beginning of the assessment year for which this waiver is sought.
- 4 All claim and site names and BLM serial numbers must be listed for the mining claims, mill sites, and tunnel sites for which the waiver is sought.
- 5 All owners of the mining claims, mill sites, and tunnel sites and their addresses must be given.
- 6 This waiver form must be signed by all the claimants or their designated agent, in original form. If an agent is designated, a notarized designation of agent, signed by all of the claimants with proper address given, must be submitted with this waiver.
- 7 This form must be filed no later than September 1st for the upcoming assessment year in the BLM State Office where the mining claims or sites are recorded, or the waiver cannot be granted by the BLM. (Example: To obtain a waiver for the assessment year 2012, which begins on September 1, 2011, you must qualify for and file for a waiver no later than September 1, 2011, in the proper BLM State Office.)
- 8 For all mining claims which require assessment work, you must record an affidavit of labor on or before the December 30th immediately following the filing of this waiver. For all other mining claims or sites waived, you must record a notice of intent to hold on or before the December 30th immediately following the filing of this waiver.
- 9 Mill and tunnel sites may also be listed on this waiver and be waived from payment of the maintenance fee. A notice of intent to hold for these sites is required to be filed by the December 30th following the filing of this waiver.

FOR OFFICIAL USE ONLY

PHOENIX, ARIZONA

2019 AUG 22 P 2:15

(Continued on page 3)

(Form 3830-2, page 2)

RECEIVED
BLM AZ STATE OFFICE

Gary Haley

Phone: (520) 648-2040

UNIT STATES
DEPARTMENT THE INTERIOR
BUREAU OF LAND MANAGEMENTM APPROVED
3 NO.: 1004-0114
Expires: January 31, 2020

AFFIDAVIT OF ANNUAL ASSESSMENT WORK

WHEN RECORDED, MAIL DOCUMENT TO:

NAME: Gary + Connie Haley
ADDRESS: PO Box 584
CITY, STATE, ZIP: Green Valley, AZ 85622

FOR COUNTY RECORDER'S USE

No. of Claims 6
x \$10/claim
Total due BLM \$ 60.00

TO ALL WHOM IT MAY CONCERN:

1. The undersigned certifies that at least \$100 per claim was expended for development, labor and improvements, or equivalent value added, as the annual assessment work for the assessment year ending September 1, 2018 for the following contiguous unpatented mining claim(s), located in the County of Pima, in the State of Arizona.

BLM Serial No.	Name of Claim	Tp	Rg	Sec	Mer	County Recordation Book and Page No.	Co. Recording Date
418628	Peachie	17 S	12 E	003	Gila & S	20123130204 page 3	11/08/2012
421122	Buzzards End	17 S	10 E	026	Gila & S	20130590127 page 2	2/28/2013
421116	Apache Moon	17 S	10 E	026	Gila & S	20130590128 page 2	2/28/2013
423064	Apache Moon 2	17 S	10 E	026	Gila & S	20131420840 page 3	5/22/2013
423063	Honeycomb	17 S	10 E	026	Gila & S	20131420839 page 3	5/22/2013
423704	Skid Mark	17 S	10 E	026	Gila & S	20132050174 page 2	7/24/2013

(Continued on page 2)

RECEIVED
BLM AZ STATE OFFICE
2018 AUG 29 P 3:02
PHOENIX, ARIZONA

#4250500

INTERESTED
SEP 06 2018
BY: Ram

2. Type of labor and improvements (specify what was done and give the total value for that labor and improvement to show at least \$100 for each claim). If a geological, geochemical, or geophysical survey was performed, as per 30 U.S.C. 28-1, reference the title of the report of survey, give cost and date of the survey and report, and indicate it was filed with the County Recorder:

Description of Work Performed	Value of Work Performed	Date Work Was Performed
checked/fixed markers, Trimed brush, Trail fix	\$ 250.	3, 19, 2018
Road work, Trash hauling, marker Repair	\$ 300.	4, 2, 2018
Trimed trees and Path improved	\$ 150.	4, 16, 2018
cleared Rock slide + Trash	\$ 400.	5, 14, 2018
Filled 3 potholes, cleared brush + trash	\$ 200.	5, 28, 2018

3. Name and mailing address of each person who performed the labor and improvements:

Name (please print)

Gary Haley
Connie Haley

Current Mailing Address (please print)

P.O. Box 584, Green Valley, AZ 85622
P.O. Box 584, Green Valley, AZ 85622

4. Name and mailing address of each person who holds and claims the subject mining claim(s) for the valuable minerals contained therein. Be sure to indicate if there is a change of address:

Name (please print)

Gary Haley
Connie Haley

Current Mailing Address (please print)

P.O. Box 584, Green Valley, AZ 85622
P.O. Box 584, Green Valley, AZ 85622

RECEIVED
BLM AZ STATE OFFICE
2018 AUG 29 P 3:02
PHOENIX, ARIZONA

5. The undersigned testifies that on the date of August, 28, 2018, all monuments required by law were erected upon the subject claim(s), and all notices required by law were posted on the subject claim(s) or copies thereof were in place, and at said date, each corner monument bore or contained

markings sufficient to appropriately designate the corner of the claim to which it pertains and the name of the claim(s).

I hereby certify under penalty of perjury under the laws of the State of Arizona that the foregoing statements are true and correct:

Gary Haley Connie Lee Y. Haley Date: 8-27-2018
(Signature of person responsible for above statement)

Title 18 U.S.C. 1001 and 43 U.S.C. 1212 make it a crime for any person knowingly and willfully to make to any department or agency of the United States any false, fictitious or fraudulent statements or representations as to any matter within its jurisdiction.

Notary Block

SUBSCRIBED AND SWORN TO before me, this 27 day of August 20 18

By: Andrea Villa
(Signature of Affiant)

Title: Notary Public

My Commission Expires: 06/29/2020

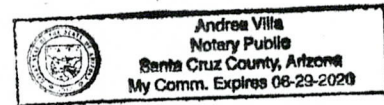

INSTRUCTIONS

1. This is an optional form that may be used to satisfy the requirements for the Bureau of Land Management (BLM) under the provisions of 43 U.S.C. §1744 and 30 U.S.C. §28-28d and the regulations thereunder (43 CFR part 3835). Since local and State laws may vary, you should contact your local and State agencies where the claims are located to ensure all applicable laws and requirements are satisfied.
2. The claimant(s) must fill in the date in paragraph 1 for the applicable assessment year and the county and state where the claims are located.
3. All claim names, BLM serial numbers, legal descriptions, and original county recording information must be listed for the claims pertaining to this assessment notice.
4. The claimant(s) must complete paragraph 2 listing all labor or improvements which was performed on or did benefit the subject mining claims. The value and date of the labor or improvements must also be listed. The total amount of labor or improvements can be listed, but the total expenditure must equal at least \$100 for each claim.
5. The names and current mailing addresses of the person(s) performing the labor shall be listed in paragraph 3.
6. The name and current mailing address of each owner (claimant) of the claims shall be listed in paragraph 4. The mailing address shall be the owner's address and not the address of an agent or anyone representing the claimant. Be sure to note if there has been a change of address.
7. Paragraph 5 shall be completed to show the date it was verified that all monuments required by law were properly erected, all notices were posted, and that corners were appropriately designated for all claims listed.
8. An exact legible reproduction or duplicate (other than microfilm or other electronic media) of this affidavit, another type of affidavit of assessment work that you file or will file in the county where each claim is located, must be filed with the BLM on or before December 30 of the calendar year in which the assessment year ends. For mill or tunnel sites, a separate notice of intent to hold must be filed with the BLM on or before December 30. Requirements for filing a notice of intent to hold can be found at 43 CFR 3835.33.
9. A processing fee of \$10 for each claim listed must be remitted to the BLM along with this or any other affidavit of assessment work.

RECEIVED
BLM AZ STATE OFFICE
2018 AUG 28 P 3:02
PHOENIX, ARIZONA

Gary Haley
Phone: (520) 648-2040



Ms. Connie Haley
PO Box 584
Green Valley, AZ 85622

PLACE STICKER AT TOP OF ENVELOPE TO THE RIGHT
OF THE RETURN ADDRESS, FOLD AT DOTTED LINE

CERTIFIED MAIL



7017 1450 0001 7527 0793



85004

U.S. POSTAGE PAID
FCM LG ENV
GREEN VALLEY, AZ
85614
AUG 27, 18
AMOUNT
\$4.66
R2304M112955-13

**UNITED STATES
DEPARTMENT OF INTERIOR**
Bureau of Land Management
Arizona State Office
One North Central Avenue, Suite 800
Phoenix, Arizona 85004-4427

RECEIVED
BLM AT STATE OFI
2018 AUG 29 P 3:02
PHOENIX, ARIZONA



United States Department of the Interior
Bureau of Land Management
DIV OF LANDS, MINRLS & ENERGY
ONE N CENTRAL AVE
PHOENIX, AZ 85004 -4427
Phone: 602-417-9200

Receipt

No: 4250500

Transaction #: 4366005	
Date of Transaction: 08/30/2018	
CUSTOMER:	
	GARY L HALEY PO BOX 584 GREEN VALLEY, AZ 85622-0584 US

LINE #	QTY	DESCRIPTION	REMARKS	UNIT PRICE	TOTAL
1	1.00	LOCATABLE MINERALS / MINING CLAIMS- NOT NEW-UNADJUD, ONE AUTH NO. ONLY / MINING CLAIM MONEY RECEIVED CASES: AMC418628/\$60.00	POL 2018/6 WAV	- n/a -	60.00
TOTAL:					\$60.00

PAYMENT INFORMATION				
1	AMOUNT:	60.00	POSTMARKED:	N/A
	TYPE:	CHECK	RECEIVED:	08/29/2018
	CHECK NO:	1499		
	NAME:	HALEY, GARY L PO BOX 584 GREEN VALLEY AZ 85622-0584 US		

REMARKS

This receipt was generated by the automated BLM Collections and Billing System and is a paper representation of a portion of the official electronic record contained therein.

UNITED STATES
DEPARTMENT OF THE INTERIOR
BUREAU OF LAND MANAGEMENT

MAINTENANCE FEE WAIVER CERTIFICATION

SEE INSTRUCTIONS ON PAGE 2

FORM APPROVED 421116
OMB NO. 1004-0114
Expires: January 31, 2020

1. This small miner waiver is filed for the assessment year beginning on September 1, ~~2017~~ and ending on September 1, ~~2018~~ 19 ~~2018~~ 19
2. The undersigned and all related parties owned ten or fewer mining claims, mill, or tunnel sites located and maintained on Federal lands in the United States of America on September 1, ~~2018~~ 19
3. The undersigned have performed the assessment work required by law for each mining claim listed prior to filing this waiver and understand that by filing this form, the undersigned must file an affidavit of assessment work with the Bureau of Land Management (BLM) by the December 30th following the filing of this waiver.
4. The undersigned understand that if the assessment work obligation has not yet come due under 30 U.S.C. 28 (for those claims in their first assessment year only), a notice of intent to hold reciting this condition must be recorded by the December 30th following the filing of this waiver.
5. The undersigned understand that mill and tunnel sites may also be listed on this waiver and be waived from payment of the maintenance fee, and that a notice of intent to hold for these sites is required to be filed with the BLM by the December 30th following the filing of this waiver.
6. The undersigned understand and acknowledge that pursuant to 43 U.S.C. 1212 and 18 U.S.C. 1001, the filing or recording of a false, fictitious, or fraudulent document with the BLM may result in a fine of up to \$250,000, a prison term not to exceed five years, or both.
7. The mining claims, mill or tunnel sites for which this waiver from payment of the maintenance fees is requested are:

CLAIM OR SITE NAME	BLM RECORDATION SERIAL NUMBER
1. Peachie	418628 (913)
2. Buzzards End	421122
3. Apache Moon	421116
4. Apache Moon 2	423064
5. Honeycomb	423063
6. Skidmark	423704
7.	
8.	
9.	
10.	

The owner(s) (claimants) of the above mining claims and sites are:

Connie Haley
(Owner's Name - Please Print)
PO Box 584, Green Valley, AZ 85622
(Owner's Mailing Address)

Connie Lee Haley
(Owner's Signature)
Green Valley AZ 85622
(City) (State) (Zip Code)

Gary Haley
(Owner's Name - Please Print)
PO Box 584, Green Valley, AZ 85622
(Owner's Mailing Address)

Gary Haley
(Owner's Signature)
Green Valley AZ 85622
(City) (State) (Zip Code)

(Owner's Name - Please Print)

(Owner's Signature)

(Owner's Mailing Address)

(City)

(State)

(Zip Code)

(Owner's Name - Please Print)

(Owner's Signature)

(Owner's Mailing Address)

(City)

(State)

(Zip Code)

(Continued on page 2)

483
ENTERED
SEP 10 2018
BY: [Signature]

RECEIVED
BLM AZ STATE OFFICE
PHOENIX, ARIZONA
AUG 29 10 3 02

WWD
R

Connie Haley

(Owner's Name - Please Print)

PO BOX 584

(Owner's Mailing Address)

X *Connie L. Haley*

(Owner's Signature)

Green Valley

(City)

AZ

(State)

85622

(Zip Code)

Gary Haley

(Owner's Name - Please Print)

PO BOX 584

(Owner's Mailing Address)

X *Gary Haley*

(Owner's Signature)

Green Valley

(City)

AZ

(State)

85622

(Zip Code)

(Owner's Name - Please Print)

(Owner's Signature)

(Owner's Mailing Address)

(City)

(State)

(Zip Code)

(Owner's Name - Please Print)

(Owner's Signature)

(Owner's Mailing Address)

(City)

(State)

(Zip Code)

18 U.S.C. 1001 and 43 U.S.C. 1212 make it a crime for any person knowingly and willfully to make to any department or agency of the United States any false, fictitious or fraudulent statements or representations as to any matter within its jurisdiction.

INSTRUCTIONS

1. This certification is made under the provisions of 43 U.S.C. § 1744 and 30 U.S.C. § 28-28k and the regulations thereunder (43 CFR Part 3830).
2. The claimant(s) must fill in the dates in paragraph 1 for the beginning and ending of the assessment year for which this waiver is sought.
3. The claimant(s) must fill in the date in paragraph 2 for the beginning of the assessment year for which this waiver is sought.
4. All claim and site names and BLM serial numbers must be listed for the mining claims, mill sites, and tunnel sites for which the waiver is sought.
5. All owners of the mining claims, mill sites, and tunnel sites and their addresses must be given.
6. This waiver form must be signed by all the claimants or their designated agent, in original form. If an agent is designated, a notarized designation of agent, signed by all of the claimants with proper address given, must be submitted with this waiver.
7. This form must be filed no later than September 1st for the upcoming assessment year in the BLM State Office where the mining claims or sites are recorded, or the waiver cannot be granted by the BLM. (Example: To obtain a waiver for the assessment year 2012, which begins on September 1, 2011, you must qualify for and file for a waiver no later than September 1, 2011, in the proper BLM State Office.)
8. For all mining claims which require assessment work, you must record an affidavit of labor on or before the December 30th immediately following the filing of this waiver. For all other mining claims or sites waived, you must record a notice of intent to hold on or before the December 30th immediately following the filing of this waiver.
9. Mill and tunnel sites may also be listed on this waiver and be waived from payment of the maintenance fee. A notice of intent to hold for these sites is required to be filed by the December 30th following the filing of this waiver.

FOR OFFICIAL USE ONLY

RECEIVED
BLM AZ STATE OFFICE
2010 AUG 29 P 3:02
PHOENIX, ARIZONA

(Continued on page 3)

Form 3830-2, page 2)

Gary Haley
Phone (520) 648-2040

Amc 418628
421116
421122
423063
423064
423704

429
Amc

Print

Clear

Form 3830-2
(January 2017)

UNITED STATES
DEPARTMENT OF THE INTERIOR
BUREAU OF LAND MANAGEMENT
MAINTENANCE FEE WAIVER CERTIFICATION

FORM APPROVED
OMB NO. 1004-0114
Expires: January 31, 2020

SEE INSTRUCTIONS ON PAGE 2

1. This small miner waiver is filed for the assessment year beginning on September 1, 2016 and ending on September 1, 2017.
2. The undersigned and all related parties owned ten or fewer mining claims, mill, or tunnel sites located and maintained on Federal lands in the United States of America on September 1, 2017.
3. The undersigned have performed the assessment work required by law for each mining claim listed prior to filing this waiver and understand that by filing this form, the undersigned must file an affidavit of assessment work with the Bureau of Land Management (BLM) by the December 30th following the filing of this waiver.
4. The undersigned understand that if the assessment work obligation has not yet come due under 30 U.S.C. 28 (for those claims in their first assessment year only), a notice of intent to hold reciting this condition must be recorded by the December 30th following the filing of this waiver.
5. The undersigned understand that mill and tunnel sites may also be listed on this waiver and be waived from payment of the maintenance fee, and that a notice of intent to hold for these sites is required to be filed with the BLM by the December 30th following the filing of this waiver.
6. The undersigned understand and acknowledge that pursuant to 43 U.S.C. 1212 and 18 U.S.C. 1001, the filing or recording of a false, fictitious, or fraudulent document with the BLM may result in a fine of up to \$250,000, a prison term not to exceed five years, or both.
7. The mining claims, mill or tunnel sites for which this waiver from payment of the maintenance fees is requested are:

CLAIM OR SITE NAME	BLM RECORDATION SERIAL NUMBER
1. <u>Peachie</u>	<input checked="" type="checkbox"/> <u>418628</u>
2. <u>Buzzards End</u>	<u>421122</u>
3. <u>Apache Moon</u>	<u>421116</u>
4. <u>Apache moon 2</u>	<u>423064</u>
5. <u>Honeycomb</u>	<u>423063</u>
6. <u>SKid Mark</u>	<u>423704</u>
7.	
8.	
9.	
10.	

The owner(s) (claimants) of the above mining claims and sites are:

Connie Haley
(Owner's Name - Please Print)
PO Box 584, Green Valley, AZ 85622
(Owner's Mailing Address)

X Connie Le Haley
(Owner's Signature)
Green Valley AZ 85622
(City) (State) (Zip Code)

Gary Haley
(Owner's Name - Please Print)
PO Box 584, Green Valley, AZ 85622
(Owner's Mailing Address)

X Gary Haley
(Owner's Signature)
Green Valley AZ 85622
(City) (State) (Zip Code)

(Owner's Name - Please Print)
(Owner's Mailing Address)
(Owner's Name - Please Print)
(Owner's Mailing Address)

(Owner's Signature)
(City) (State) (Zip Code)
(Owner's Signature)
(City) (State) (Zip Code)

(Continued on page 2)

483
ENTERED
SEP 12 2017
BY: pn

RECEIVED
BLM
AZ STATE OFFICE
2017 AUG 23 A 7:51
PHOENIX, ARIZONA

nmw
m

Connie Haley

(Owner's Name - Please Print)

PO Box 584

(Owner's Mailing Address)

X Connie Lee Haley

(Owner's Signature)

Green Valley

(City)

AZ

(State)

85622

(Zip Code)

Gary Haley

(Owner's Name - Please Print)

PO Box 584

(Owner's Mailing Address)

X Gary Haley

(Owner's Signature)

Green Valley

(City)

AZ

(State)

85622

(Zip Code)

(Owner's Name - Please Print)

(Owner's Signature)

(Owner's Mailing Address)

(City)

(State)

(Zip Code)

(Owner's Name - Please Print)

(Owner's Signature)

(Owner's Mailing Address)

(City)

(State)

(Zip Code)

18 U.S.C. 1001 and 43 U.S.C. 1212 make it a crime for any person knowingly and willfully to make to any department or agency of the United States any false, fictitious or fraudulent statements or representations as to any matter within its jurisdiction.

INSTRUCTIONS

1. This certification is made under the provisions of 43 U.S.C. § 1744 and 30 U.S.C. § 28-28k and the regulations thereunder (43 CFR Part 3830).
2. The claimant(s) must fill in the dates in paragraph 1 for the beginning and ending of the assessment year for which this waiver is sought.
3. The claimant(s) must fill in the date in paragraph 2 for the beginning of the assessment year for which this waiver is sought.
4. All claim and site names and BLM serial numbers must be listed for the mining claims, mill sites, and tunnel sites for which the waiver is sought.
5. All owners of the mining claims, mill sites, and tunnel sites and their addresses must be given.
6. This waiver form must be signed by all the claimants or their designated agent, in original form. If an agent is designated, a notarized designation of agent, signed by all of the claimants with proper address given, must be submitted with this waiver.
7. This form must be filed no later than September 1st for the upcoming assessment year in the BLM State Office where the mining claims or sites are recorded, or the waiver cannot be granted by the BLM. (Example: To obtain a waiver for the assessment year 2012, which begins on September 1, 2011, you must qualify for and file for a waiver no later than September 1, 2011, in the proper BLM State Office.)
8. For all mining claims which require assessment work, you must record an affidavit of labor on or before the December 30th immediately following the filing of this waiver. For all other mining claims or sites waived, you must record a notice of intent to hold on or before the December 30th immediately following the filing of this waiver.
9. Mill and tunnel sites may also be listed on this waiver and be waived from payment of the maintenance fee. A notice of intent to hold for these sites is required to be filed by the December 30th following the filing of this waiver.

FOR OFFICIAL USE ONLY

PHOENIX, ARIZONA

2011 AUG 23 A 7:51

RECEIVED
BLM AZ STATE OFFICE

(Continued on page 3)

Form 3830-2, page 2

Gary Haley

Phone # (520) 648-2040

Form 3830-4
(January 2017)

UNITED STATES
DEPARTMENT OF THE INTERIOR
BUREAU OF LAND MANAGEMENT

AFFIDAVIT OF ANNUAL ASSESSMENT WORK

FORM APPROVED
OMB NO.: 1004-0114
Expires: January 31, 2020

WHEN RECORDED, MAIL DOCUMENT TO:

NAME: Gary + Connie Haley
ADDRESS: Po Box 584
CITY, STATE, ZIP: Green Valley, AZ 85622

FOR COUNTY RECORDER'S USE

No. of Claims 6
x \$10/claim
Total due BLM \$ 60.00

TO ALL WHOM IT MAY CONCERN:

1. The undersigned certifies that at least \$100 per claim was expended for development, labor and improvements, or equivalent value added, as the annual assessment work for the assessment year ending September 1, 2017 for the following contiguous unpatented mining claim(s), located in the County of Pima in the State of Arizona.

BLM Serial No.	Name of Claim	Tp	Rg	Sec	Mex	County Recordation Book and Page No.	Date
		Example: 13N 5E 14 MDM					
418628	Peachie	17 S	12 E	003	Gila & S	20123130204 page 3	11/08/2012
421122	Buzzards End	17 S	10 E	026	Gila & S	20130590127 page 2	2/28/2013
421116	Apache Moon	17 S	10 E	026	Gila & S	20130590128 page 2	2/28/2013
423064	Apache Moon 2	17 S	10 E	026	Gila & S	20131420840 page 3	5/22/2013
423063	Honeycomb	17 S	10 E	026	Gila & S	20131420839 page 3	5/22/2013
423704	Skid Mark	17 S	10 E	026	Gila & S	20132050174 page 2	7/24/2013

(Continued on page 2)

3954860

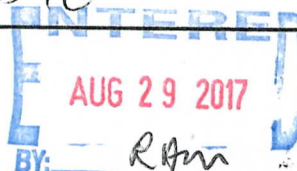

RECEIVED
BLM AZ STATE OFFICE
2017 AUG 23 A 7:51
PUEBLO, ARIZONA

2. Type of labor and improvements (specify what was done and give the total value for that labor and improvement to show at least \$100 for each claim). If a geological, geochemical, or geophysical survey was performed, as per 30 U.S.C. 28-1, reference the title of the report of survey, give cost and date of the survey and report, and indicate it was filed with the County Recorder:

Description of Work Performed	Value of Work Performed	Date Work Was Performed
Filled potholes, Cleared brush, Removed trash	\$400.	3, 20, 17
checked + fixed claim markers, Removed trash	\$150.	4, 16, 17
Improved Path, fixed markers	\$175.	4, 24, 17
Trimmed trees, Cleared trash	\$200.	5, 15, 17
Moved Rocks from Road, Removed trash, Markers	\$250.	5, 29, 17

3. Name and mailing address of each person who performed the labor and improvements:

Name (please print)

Gary Haley
Connie Haley

Current Mailing Address (please print)

PO BOX 584, Green Valley, AZ 85622
PO BOX 584, Green Valley, AZ 85622

4. Name and mailing address of each person who holds and claims the subject mining claim(s) for the valuable minerals contained therein. Be sure to indicate if there is a change of address:

Name (please print)

Gary Haley
Connie Haley

Current Mailing Address (please print)

PO BOX 584, Green Valley, AZ 85622
PO BOX 584, Green Valley, AZ 85622

5. The undersigned testifies that on the date of August 22, 2017, all monuments required by law were erected upon the subject claim(s), and all notices required by law were posted on the subject claim(s) or copies thereof were in place, and at said date, each corner monument bore the following:

(Continued on page 3)

RECEIVED
STATE OFFICE
AUG 23 A 7:52
PHOENIX, ARIZONA

markings sufficient to appropriately designate the corner of the claim to which it pertains and the name of the claim(s).

I hereby certify under penalty of perjury under the laws of the State of Arizona that the foregoing statements are true and correct:

Garry L. Haley Gary Haley
(Signature of person responsible for above statement)

Date: 8-21-2017

Title 18 U.S.C. 1001 and 43 U.S.C. 1212 make it a crime for any person knowingly and willfully to make to any department or agency of the United States any false, fictitious or fraudulent statements or representations as to any matter within its jurisdiction.

Notary Block

SUBSCRIBED AND SWORN TO before me, this 21st day of August 20 17

By: Rose Mendoza
(Signature of Affiant)

Title: NOTARY

My Commission Expires: OCT. 28, 2018

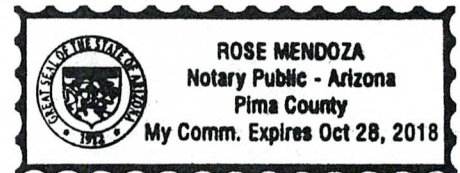

INSTRUCTIONS

1. This is an optional form that may be used to satisfy the requirements for the Bureau of Land Management (BLM) under the provisions of 43 U.S.C. §1744 and 30 U.S.C. §28-28d and the regulations thereunder (43 CFR part 3835). Since local and State laws may vary, you should contact your local and State agencies where the claims are located to ensure all applicable laws and requirements are satisfied.
2. The claimant(s) must fill in the date in paragraph 1 for the applicable assessment year and the county and state where the claims are located.
3. All claim names, BLM serial numbers, legal descriptions, and original county recording information must be listed for the claims pertaining to this assessment notice.
4. The claimant(s) must complete paragraph 2 listing all labor or improvements which was performed on or did benefit the subject mining claims. The value and date of the labor or improvements must also be listed. The total amount of labor or improvements can be listed, but the total expenditure must equal at least \$100 for each claim.
5. The names and current mailing addresses of the person(s) performing the labor shall be listed in paragraph 3.
6. The name and current mailing address of each owner (claimant) of the claims shall be listed in paragraph 4. The mailing address shall be the owner's address and not the address of an agent or anyone representing the claimant. Be sure to note if there has been a change of address.
7. Paragraph 5 shall be completed to show the date it was verified that all monuments required by law were properly erected, all notices were posted, and that corners were appropriately designated for all claims listed.
8. An exact legible reproduction or duplicate (other than microfilm or other electronic media) of this affidavit or another type of affidavit of assessment work that you file or will file in the county where each claim is located must be filed with the BLM on or before December 30 of the calendar year in which the assessment year ends. For mill or tunnel sites, a separate notice of intent to hold must be filed with the BLM on or before December 30. Requirements for filing a notice of intent to hold can be found at 43 CFR 3835.33.
9. A processing fee of \$10 for each claim listed must be remitted to the BLM along with this or another affidavit of assessment work.

(Continued on page 4)

RECEIVED
STATE OFFICE
AUG 23 4 15 PM
PIMA COUNTY, ARIZONA

Garry Haley
Phone #(520) 648-2040

Connie & Gary Haley
PO Box 584
Green Valley, AZ 85622



1006



85004

U.S. POSTAGE
PAID
SAHUARITA, AZ
85629
AUG 21, 17
AMOUNT
\$6.65
R2304H109228-07

Expected Delivery Day: 08/23/2017

USPS TRACKING NUMBER



9505 5123 7573 7233 1981 37

**UNITED STATES
DEPARTMENT OF INTERIOR**
Bureau of Land Management
Arizona State Office
One North Central Avenue, Suite 800
Phoenix, Arizona 85004-4427



RECEIVED
BLM
2017 AUG 23 A 1:51
PHOENIX ARIZONA

United States Department of the Interior
Bureau of Land Management
DIV OF LANDS, MINRLS & ENERGY
ONE N CENTRAL AVE
PHOENIX, AZ 85004 -4427
Phone: 602-417-9200

Receipt

No: 3954860

Transaction #: 4064624	
Date of Transaction: 08/24/2017	
CUSTOMER:	
	CONNIE HALEY PO BOX 584 GREEN VALLEY, AZ 85622 US

LINE #	QTY	DESCRIPTION	REMARKS	UNIT PRICE	TOTAL
1	1.00	LOCATABLE MINERALS / MINING CLAIMS- NOT NEW-UNADJUD, ONE AUTH NO. ONLY / MINING CLAIM MONEY RECEIVED CASES: AMC418628/\$60.00	MAINT 2018/6 WAV	- n/a -	60.00
TOTAL:					\$60.00

PAYMENT INFORMATION				
1	AMOUNT:	60.00	POSTMARKED:	08/21/2017
	TYPE:	CHECK	RECEIVED:	08/23/2017
	CHECK NO:	1320		
	NAME:	HALEY, CONNIE L PO BOX 584 GREEN VALLEY AZ 85622 US		

REMARKS

This receipt was generated by the automated BLM Collections and Billing System and is a paper representation of a portion of the official electronic record contained therein.

UNITED STATES
DEPARTMENT OF THE INTERIOR
BUREAU OF LAND MANAGEMENT

FORM APPROVED
OMB NO.: 1004-0114
Expires: October 31, 2016

AFFIDAVIT OF ANNUAL ASSESSMENT WORK

418628
421122
421116

WHEN RECORDED, MAIL DOCUMENT TO:

NAME: Gary + Connie Haley
ADDRESS: PO Box 584
CITY, STATE, ZIP: Green Valley, AZ 85622

423064
423063
423704

FOR COUNTY RECORDER'S USE

No. of Claims 6
x \$10/claim
Total due BLM \$ 60.00

TO ALL WHOM IT MAY CONCERN:

1. The undersigned certifies that at least \$100 per claim was expended for development, labor and improvements, or equivalent value added, as the annual assessment work for the assessment year ending September 1, 2016 for the following contiguous unpatented mining claim(s), located in the County of Pima, in the State of Arizona.

BLM Serial No.	Name of Claim	Tp	Rg	Sec	Mer	County Recordation Book and Page No.	Date
418628	Peachie	17 S	12 E	003	Gila & S	20123130204 page 3	11/08/2012
421122	Buzzards End	17 S	10 E	026	Gila & S	20130590127 page 2	2/28/2013
421116	Apache Moon	17 S	10 E	026	Gila & S	20130590128 page 2	2/28/2013
423064	Apache Moon 2	17 S	10 E	026	Gila & S	20131420840 page 3	5/22/2013
423063	Honeycomb	17 S	10 E	026	Gila & S	20131420839 page 3	5/22/2013
423704	Skid Mark	17 S	10 E	026	Gila & S	20132050174 page 2	7/24/2013

(Continued on page 2)

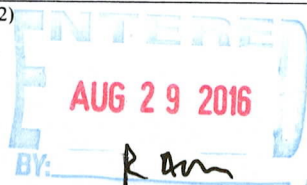

RECEIPT # 3642474

RECEIVED
BLM AZ STATE OFFICE
2016 AUG 25 P 2:18
PHOENIX, ARIZONA

2. Type of labor and improvements (specify what was done and give the total value for that labor and improvement to show at least \$100 for each claim). If a geological, geochemical, or geophysical survey was performed, as per 30 U.S.C. 28-1, reference the title of the report of survey, give cost and date of the survey and report, and indicate it was filed with the County Recorder:

Description of Work Performed	Value of Work Performed	Date Work Was Performed
Improved roads, removed trash, cut brush	\$ 250.	March, 14, 15
Checked + fixed claim markers, cleared brush, trash	\$ 150.	March, 21, 15
Leveled roads, removed rock	\$ 400.	April, 11, 15
Fixed potholes, Trash removal	\$ 250.	May, 9, 15
Removed brush, filled potholes for access.	\$ 200.	May, 23, 15

3. Name and mailing address of each person who performed the labor and improvements:

Name (please print)

Gary Haley
Connie Haley

Current Mailing Address (please print)

PO Box 584, Green Valley, AZ 85622
PO Box 584, Green Valley, AZ 85622

4. Name and mailing address of each person who holds and claims the subject mining claim(s) for the valuable minerals contained therein. Be sure to indicate if there is a change of address:

Name (please print)

Gary Haley
Connie Haley

Current Mailing Address (please print)

PO Box 584, Green Valley 85622
PO Box 584, Green Valley 85622

RECEIVED
BLM AZ STATE OFFICE
2016 AUG 25 P 2:18
PHOENIX, ARIZONA

5. The undersigned testifies that on the date of August, 23, 2016, all monuments required by law were erected upon the subject claim(s), and all notices required by law were posted on the subject claim(s) or copies thereof were in place, and at said date, each corner monument bore or contained

2016 AUG 25 P 2:18

PHOENIX, ARIZONA

markings sufficient to appropriately designate the corner of the claim to which it pertains and the name of the claim(s).

I hereby certify under penalty of perjury under the laws of the State of Arizona that the foregoing statements are true and correct:

X Connie L. Haley / Mary Haley Date: X 8-23-2016
(Signature of person responsible for above statement)

Title 18 U.S.C. 1001 and 43 U.S.C. 1212 make it a crime for any person knowingly and willfully to make to any department or agency of the United States any false, fictitious or fraudulent statements or representations as to any matter within its jurisdiction.

Notary Block

SUBSCRIBED AND SWORN TO before me, this 23rd day of August 202016

By: [Signature]
(Signature of Affiant)

Title: Branch Mgr

My Commission Expires: 1-2-2020

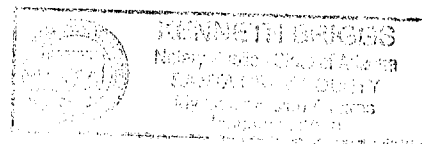

INSTRUCTIONS

1. This is an optional form that may be used to satisfy the requirements for the Bureau of Land Management (BLM) under the provisions of 43 U.S.C. §1744 and 30 U.S.C. §28-28d and the regulations thereunder (43 CFR part 3835). Since local and State laws may vary, you should contact your local and State agencies where the claims are located to ensure all applicable laws and requirements are satisfied.
2. The claimant(s) must fill in the date in paragraph 1 for the applicable assessment year and the county and state where the claims are located.
3. All claim names, BLM serial numbers, legal descriptions, and original county recording information must be listed for the claims pertaining to this assessment notice.
4. The claimant(s) must complete paragraph 2 listing all labor or improvements which was performed on or did benefit the subject mining claims. The value and date of the labor or improvements must also be listed. The total amount of labor or improvements can be listed, but the total expenditure must equal at least \$100 for each claim.
5. The names and current mailing addresses of the person(s) performing the labor shall be listed in paragraph 3.
6. The name and current mailing address of each owner (claimant) of the claims shall be listed in paragraph 4. The mailing address shall be the owner's address and not the address of an agent or anyone representing the claimant. Be sure to note if there has been a change of address.
7. Paragraph 5 shall be completed to show the date it was verified that all monuments required by law were properly erected, all notices were posted, and that corners were appropriately designated for all claims listed.
8. An exact legible reproduction or duplicate (other than microfilm or other electronic media) of this affidavit or another type of affidavit of assessment work that you file or will file in the county where each claim is located, must be filed with the BLM on or before December 30 of the calendar year in which the assessment year ends. For mill or tunnel sites, a separate notice of intent to hold must be filed with the BLM on or before December 30. Requirements for filing a notice of intent to hold can be found at 43 CFR 3835.33.
9. A processing fee of \$10 for each claim listed must be remitted to the BLM along with this or any other affidavit of assessment work.

NOTICE OF INTENTION TO HOLD MINING CLAIMS/SITES

When Recorded Return Document to:

Gary + Connie Haley
PO Box 584
Green Valley, AZ 85622

BLM
Date
Stamp

RECEIVED
BLM AZ STATE OFFICE
2016 AUG 25 P 2:18
PHOENIX, ARIZONA

☐ Check here if this is a change of address.

Telephone: (520) 648-2040

E-mail Address: adamsplace773@peoplepc.com

8/30/16
8:33A... I called and
left a msg.

I (We) intend to hold the claims(s) and/or site(s) listed below for the calendar year 2017, and I (We) have filed or will file a Notice of Intent to Hold in the county where the claim (s) is located.

Reason for filing a Notice of Intent to Hold instead of an assessment work filing (check one):

- ☐ Maintenance fee was paid to maintain claim(s) during this assessment year.
☐ Mill or tunnel sites.
☐ Claim(s) was located during the current assessment year.
☒ BLM has deferred assessment work (attach copy of decision granting deferment, or pending petition for deferment including date petition was filed.)

Line No.	AMC NUMBER	CLAIM/SITE NAME	COUNTY RECORDER DATA (If available)	TWP	RNG	SEC
1	418628	Peachie	20123130204	17S	12E	003
2	421122	Buzzards End	20130590127	17S	10E	026
3	421166	Apache Moon	20130590128	17S	10E	026
4	423064	Apache Moon 2	20131420840	17S	10E	026
5	423063	Honey Comb	20131420839	17S	10E	026
6	423704	Skid Mark	20132050174	17S	10E	026
7						
8						
9						
10						

This NOT Form is OPTIONAL; the above claims have been under a Waiver since 2015. PB

Form: MCF110
Revised July 2014
Page 1 of 2

8/30/16 (3:14pm) Mr. Haley called - stated if the NOI is not necessary; please disregard it, he will send his request via Email as well. Email MSG Recd on 8/30/16 2:43pm (Attached).

NOTICE OF INTENTION TO HOLD MINING CLAIMS/SITES
page 2

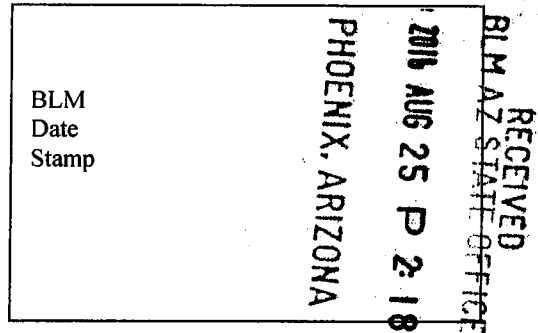

1. State of Arizona, County of Pima

2. I (Name) Connie Haley, Gary Haley

3. Reside at (Address) 16621 Horse Hollow Trail

City Sahuarita County Pima State AZ Zip 85629 being duly sworn, depose and say that I am a citizen of the United States, more than eighteen years of age, that all of the facts set forth in this notice, subject to the provisions and penalties of 18 U.S.C. 1001 pertaining to the filing of false, fictitious, or fraudulent statements with the United States, are true and correct according to the best of my knowledge, information and belief.

4. Owner's name and address (If not shown in Items 1-3 above). Connie Haley + Gary Haley

5. Dated: 8/23/2016 Signature: Connie L. Haley, Gary Haley

Bureau of Land Management
Arizona State Office
www.blm.gov/az

No. of Claims: _____ x \$10 = _____
Check No: _____ Init. _____
Receipt No.: _____
For BLM Use Only

Form: MCF110
Revised July 2014
Page 2 of 2



Brown, Pauline <paulinebrown@blm.gov>

AMC418628, ET AL

1 message

Brown, Pauline <paulinebrown@blm.gov>

Tue, Aug 30, 2016 at 9:39 AM

To: adamsplace773@peoplec.com

To Gary and Connie Haley,

On August 25, 2016, this office received a payment for \$60 (Receipt #3642474); with the payment, you submitted a Notice of intention (NOI) to hold mining claims form (Form: MCF110) and the Affidavit of annual assessment work (POL) form (Form 3830-4).

For your information, the \$60 payment was applied towards the assessment work on the 6 claims you listed on the POL form. The NOI form is 'optional' at this time because you have been filing a waiver on the same 6 claims since 2015.

If you still want us to process the NOI form, you will need to send in an additional \$60 because the fee to process the NOI is \$10 per mining claim. If you have any questions please feel free to call.

Regards,

PAULINE BROWN
LAND LAW EXAMINER
BUREAU OF LAND MANAGEMENT
ARIZONA STATE OFFICE
ONE NORTH CENTRAL AVE, STE 800
PHOENIX, AZ 85004-4427
OFFICE: (602) 417-9360
FAX: (602) 417-9490; 602-417-9452
paulinebrown@blm.gov
www.blm.gov/az
<https://www.facebook.com/BLMArizona>



Connie Agency
PO Box 584
Green Valley, AZ 85622-0584

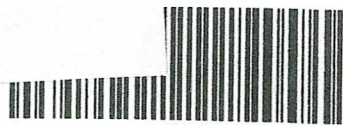

7015 3430 0001 0100 1387



1000



85004

U.S. POSTAGE
PAID
GREEN VALLEY, AZ
85614
AUG 23 16
AMOUNT
\$4.45
R2303S101109-13

RECEIVED
BLM AZ STATE OFFICE
2016 AUG 25 P 2:17
PHOENIX, ARIZONA

**UNITED STATES
DEPARTMENT OF INTERIOR**
Bureau of Land Management
Arizona State Office
One North Central Avenue, Suite 800
Phoenix, Arizona 85004-4427

Customer Name Update Screen

System ID:MC

Name:	HALEY CONNIE	<input type="button" value="Lookup"/>	<input type="text"/>
Proprietor #:	2336331	Renumber To:	<input type="text"/>
Category:	P - PRIVATE		
Address:	PO BOX 584		
	<input type="text"/>		
City:	GREEN VALLEY		
State:	AZ	<input type="button" value="Lookup"/>	
Zip:	856220584		
	<input type="checkbox"/> UNDELIVERABLE		
Email:	adamsplace773@peoplec.com		
Phone:	520-648-2040		

ENTERED AUG 30 2016

*Email / ph
fb*

<input type="button" value="Save"/>	<input type="button" value="Save/Override DataFlux"/>
<input type="button" value="Delete"/>	<input type="button" value="Renumber"/>

Customer details successfully saved for Customer Id 2336331

Customer Name Update Screen

System ID:MC

Name:HALEY GARY

Lookup

Proprietor #:2336330

Renumber To:

Category:P - PRIVATE

Address:PO BOX 584

City:GREEN VALLEY

State:AZ

Lookup

Zip:856220584

☐ UNDELIVERABLE

Email:adamsplace773@peoplec.com

Phone:520-648-2040

ENTERED AUG 30 2016

PB

Save

Save/Override DataFlux

Delete

Renumber

Customer details successfully saved for Customer Id 2336330

United States Department of the Interior
Bureau of Land Management
DIV OF LANDS, MINRLS & ENERGY
ONE N CENTRAL AVE
PHOENIX, AZ 85004 -4427
Phone: 602-417-9200

Receipt

No:

3642474

Transaction #: 3746430	
Date of Transaction: 08/26/2016	
CUSTOMER:	
	CONNIE HALEY PO BOX 584 GREEN VALLEY, AZ 85622 US

LINE #	QTY	DESCRIPTION	REMARKS	UNIT PRICE	TOTAL
1	1.00	LOCATABLE MINERALS / MINING CLAIMS- NOT NEW-UNADJUD, ONE AUTH NO. ONLY / MINING CLAIM MONEY RECEIVED CASES: AMC418628/\$60.00	<i>optional</i> NOI/POL 2016 - 6	- n/a -	60.00
TOTAL:					\$60.00

PAYMENT INFORMATION				
1	AMOUNT:	60.00	POSTMARKED:	08/23/2016
	TYPE:	CHECK	RECEIVED:	08/25/2016
	CHECK NO:	1136		
	NAME:	HALEY, CONNIE L PO BOX 584 GREEN VALLEY AZ 85622 US		

REMARKS

This receipt was generated by the automated BLM Collections and Billing System and is a paper representation of a portion of the official electronic record contained therein.



Brown, Pauline <paulinebrown@blm.gov>

AMC418628, ET AL

4 messages

Brown, Pauline <paulinebrown@blm.gov>
To: adamsplace773@peoplec.com

Tue, Aug 30, 2016 at 9:39 AM

To Gary and Connie Haley,

On August 25, 2016, this office received a payment for \$60 (Receipt #3642474); with the payment, you submitted a Notice of interntion (NOI) to hold mining claims form (Form: MCF110) and the Affidavit of annual assessment work (POL) form (Form 3830-4).

For your information, the \$60 payment was applied towards the assessment work on the 6 claims you listed on the POL form. The NOI form is 'optional' at this time because you have been filing a waiver on the same 6 claims since 2015.

If you still want us to process the NOI form, you will need to send in an additional \$60 because the fee to process the NOI is \$10 per mining claim. If you have any questions please feel free to call.

Regards,

—
PAULINE BROWN
LAND LAW EXAMINER
BUREAU OF LAND MANAGEMENT
ARIZONA STATE OFFICE
ONE NORTH CENTRAL AVE, STE 800
PHOENIX, AZ 85004-4427
OFFICE: (602) 417-9360
FAX: (602) 417-9490; 602-417-9452
paulinebrown@blm.gov
www.blm.gov/az
<https://www.facebook.com/BLMArizona>

Brown, Pauline <paulinebrown@blm.gov>
To: adamsplace773@peoplec.com

Tue, Aug 30, 2016 at 3:27 PM

Sorry, I forgot the p in the message sent today at 9:39am.
Thank you for returning my call.

Regards,

----- Forwarded message -----
From: **Brown, Pauline** <paulinebrown@blm.gov>
Date: Tue, Aug 30, 2016 at 9:39 AM
Subject: AMC418628, ET AL
To: adamsplace773@peoplec.com

To Gary and Connie Haley,

On August 25, 2016, this office received a payment for \$60 (Receipt #3642474); with the payment, you submitted a Notice of interntion (NOI) to hold mining claims form (Form: MCF110) and the Affidavit of annual assessment work (POL) form (Form 3830-4).

For your information, the \$60 payment was applied towards the assessment work on the 6 claims you listed on the POL form. The NOI form is 'optional' at this time because you have been filing a waiver on the same 6 claims since 2015.

If you still want us to process the NOI form, you will need to send in an additional \$60 because the fee to process the NOI is \$10 per mining claim. If you have any questions please feel free to call.

Regards,

PAULINE BROWN

LAND LAW EXAMINER

BUREAU OF LAND MANAGEMENT
ARIZONA STATE OFFICE
ONE NORTH CENTRAL AVE, STE 800
PHOENIX, AZ 85004-4427

OFFICE: (602) 417-9360

FAX: (602) 417-9490; 602-417-9452

paulinebrown@blm.gov

www.blm.gov/az

<https://www.facebook.com/BLMArizona>

PAULINE BROWN

LAND LAW EXAMINER

BUREAU OF LAND MANAGEMENT
ARIZONA STATE OFFICE
ONE NORTH CENTRAL AVE, STE 800
PHOENIX, AZ 85004-4427

OFFICE: (602) 417-9360

FAX: (602) 417-9490; 602-417-9452

paulinebrown@blm.gov

www.blm.gov/az

<https://www.facebook.com/BLMArizona>

Sender A <adamsplace773@peoplepc.com>
Reply-To: Sender A <adamsplace773@peoplepc.com>
To: "Brown,Pauline" <paulinebrown@blm.gov>

Tue, Aug 30, 2016 at 3:36 PM

Dear Pauline Brown,

I'm writing to confirm please DO NOT process the "Notice Of Intent form" that was incorrectly added with Affidavit of assessment work forms.

Thank you for all your assistance, Gary Haley

—Original Message—

From: "Brown, Pauline"

Sent: Aug 30, 2016 3:27 PM

To: adamsplace773@peoplepc.com

Subject: Fwd: AMC418628, ET AL

Sorry, I forgot the p in the message sent today at 9:39am.
Thank you for returning my call.

Regards,

— Forwarded message —

From: **Brown, Pauline** <paulinebrown@blm.gov>

Date: Tue, Aug 30, 2016 at 9:39 AM

Subject: AMC418628, ET AL

To: adamsplace773@peoplepc.com

To Gary and Connie Haley,

On August 25, 2016, this office received a payment for \$60 (Receipt #3642474); with the payment, you submitted a Notice of interntion (NOI) to hold mining claims form (Form: MCF110) and the Affidavit of annual assessment work (POL) form (Form 3830-4).

For your information, the \$60 payment was applied towards the assessment work on the claims you listed on the POL form. The NOI form is 'optional' at this time because you have been filing a waiver or the same 6 claims since 2015.

If you still want us to process the NOI form, you will need to send in an additional \$60 because the fee to process the NOI is \$10 per mining claim. If you have any questions please feel free to call.

Regards,

PAULINE BROWN

LAND LAW EXAMINER

BUREAU OF LAND MANAGEMENT
ARIZONA STATE OFFICE
ONE NORTH CENTRAL AVE, STE 800
PHOENIX, AZ 85004-4427

OFFICE: (602) 417-9360

FAX: (602) 417-9490; 602-417-9452

paulinebrown@blm.gov

www.blm.gov/az

<https://www.facebook.com/BLMArizona>

PAULINE BROWN

LAND LAW EXAMINER

BUREAU OF LAND MANAGEMENT
ARIZONA STATE OFFICE
ONE NORTH CENTRAL AVE, STE 800
PHOENIX, AZ 85004-4427

OFFICE: (602) 417-9360

FAX: (602) 417-9490; 602-417-9452

paulinebrown@blm.gov

www.blm.gov/az

<https://www.facebook.com/BLMArizona>

Brown, Pauline <paulinebrown@blm.gov>
To: Sender A <adamsplace773@peoplepc.com>

Tue, Aug 30, 2016 at 3:43 PM

Yes Sir, thank you for responding to my email message, I will attach this message to your packet to be filed.

Take care,

On Tue, Aug 30, 2016 at 3:36 PM, Sender A <adamsplace773@peoplepc.com> wrote:

Dear Pauline Brown,

I'm writing to confirm please DO NOT process the "Notice Of Intent form" that was incorrectly added with Affidavit of assessment work forms.

Thank you for all your assistance, Gary Haley

NOI Form X'd out
8/30/16
PB

—Original Message—

From: "Brown, Pauline"

Sent: Aug 30, 2016 3:27 PM

To: adamsplace773@peoplepc.com

Subject: Fwd: AMC418628, ET AL

Sorry, I forgot the p in the message sent today at 9:39am.

Thank you for returning my call.

Regards,

— Forwarded message —

From: Brown, Pauline <paulinebrown@blm.gov>

Date: Tue, Aug 30, 2016 at 9:39 AM
Subject: AMC418628, ET AL
To: adamsplace773@peoplec.com

To Gary and Connie Haley,

On August 25, 2016, this office received a payment for \$60 (Receipt #3642474); with the payment, you submitted a Notice of intertnion (NOI) to hold mining claims form (Form: MCF110) and the Affidavit of annual assessment work (POL) form (Form 3830-4).

For your information, the \$60 payment was applied towards the assessment work on the 6 claims you listed on the POL form. The NOI form is 'optional' at this time because you have been filing a waiver on the same 6 claims since 2015.

If you still want us to process the NOI form, you will need to send in an additional \$60 because the fee to process the NOI is \$10 per mining claim. If you have any questions please feel free to call.

Regards,

—
PAULINE BROWN
LAND LAW EXAMINER
BUREAU OF LAND MANAGEMENT
ARIZONA STATE OFFICE
ONE NORTH CENTRAL AVE, STE 800
PHOENIX, AZ 85004-4427
OFFICE: (602) 417-9360
FAX: (602) 417-9490; 602-417-9452
paulinebrown@blm.gov
www.blm.gov/az
<https://www.facebook.com/BLMArizona>

—
PAULINE BROWN
LAND LAW EXAMINER
BUREAU OF LAND MANAGEMENT
ARIZONA STATE OFFICE
ONE NORTH CENTRAL AVE, STE 800
PHOENIX, AZ 85004-4427
OFFICE: (602) 417-9360
FAX: (602) 417-9490; 602-417-9452
paulinebrown@blm.gov
www.blm.gov/az
<https://www.facebook.com/BLMArizona>

—
PAULINE BROWN
LAND LAW EXAMINER
BUREAU OF LAND MANAGEMENT
ARIZONA STATE OFFICE
ONE NORTH CENTRAL AVE, STE 800
PHOENIX, AZ 85004-4427
OFFICE: (602) 417-9360
FAX: (602) 417-9490; 602-417-9452
paulinebrown@blm.gov
www.blm.gov/az
<https://www.facebook.com/BLMArizona>

MINING CLAIMS
MC Customer Information - With Serial No. and Last Assessment Code
ACTIVE CLAIMS

Page 1 of 1

Admin State: AZ

Geo State: AZ

HALEY GARY
PO BOX 584
GREEN VALLEY, AZ 85622-0584**CUSTOMER ID: 2336330**

<u>Serial No.</u>	<u>Claim Name/Number</u>	<u>Last Assmt Code</u>	<u>Last Assmt YR</u>	<u>Disposition</u>
AMC418628	PEACHIE	483	2016	ACTIVE
AMC421116	APACHE MOON	483	2016	ACTIVE
AMC421122	BUZZARDS END	483	2016	ACTIVE
AMC423063	HONEY COMB	483	2016	ACTIVE
AMC423064	APACHE MOON 2	483	2016	ACTIVE
AMC423704	SKID MARK	483	2016	ACTIVE

Number of ACTIVE cases: 6

UNITED STATES
DEPARTMENT OF THE INTERIOR
BUREAU OF LAND MANAGEMENT

421

MAINTENANCE FEE WAIVER CERTIFICATION

SEE INSTRUCTIONS ON PAGE 2

418628 423063
421116 423064
421122 423704
FORM APPROVED
OMB NO. 1004-0114
Expires: October 31, 2016

1. This small miner waiver is filed for the assessment year beginning on September 1, 2015⁶⁻¹⁰ and ending on September 1, 2016⁷⁻¹⁰.
2. The undersigned and all related parties owned ten or fewer mining claims, mill, or tunnel sites located and maintained on Federal lands in the United States of America on September 1, 2016.
3. The undersigned have performed the assessment work required by law for each mining claim listed prior to filing this waiver and understand that by filing this form, the undersigned must file an affidavit of assessment work with the Bureau of Land Management (BLM) by the December 30th following the filing of this waiver.
4. The undersigned understand that if the assessment work obligation has not yet come due under 30 U.S.C. 28 (for those claims in their first assessment year only), a notice of intent to hold reciting this condition must be recorded by the December 30th following the filing of this waiver.
5. The undersigned understand that mill and tunnel sites may also be listed on this waiver and be waived from payment of the maintenance fee, and that a notice of intent to hold for these sites is required to be filed with the BLM by the December 30th following the filing of this waiver.
6. The undersigned understand and acknowledge that pursuant to 43 U.S.C. 1212 and 18 U.S.C. 1001, the filing or recording of a false, fictitious, or fraudulent document with the BLM may result in a fine of up to \$250,000, a prison term not to exceed five years, or both.
7. The mining claims, mill or tunnel sites for which this waiver from payment of the maintenance fees is requested are:

CLAIM OR SITE NAME	BLM RECORDATION SERIAL NUMBER
1. PEACHIE	418628 ✓
2. BUZZARDS END	421122
3. APACHE MOON	421116
4. APACHE MOON 2	423064
5. HONEYCOMB	423063
6. SKID MARK	423704
7.	
8.	
9.	
10.	

RECEIVED
BLM AZ STATE OFFICE
2016 AUG 25 P 2:18
PHOENIX, ARIZONA

The owner(s) (claimants) of the above mining claims and sites are:

Connie Haley

(Owner's Name - Please Print)

PO Box 584, Green Valley, AZ 85622

(Owner's Mailing Address)

X *Connie L. Haley*

(Owner's Signature)

Green Valley

AZ

85622

(City)

(State)

(Zip Code)

Gary Haley

(Owner's Name - Please Print)

PO Box 584, Green Valley, AZ 85622

(Owner's Mailing Address)

X *Gary Haley*

(Owner's Signature)

Green Valley

AZ

85622

(City)

(State)

(Zip Code)

(Owner's Name - Please Print)

(Owner's Signature)

(Owner's Mailing Address)

(City)

(State)

(Zip Code)

(Owner's Name - Please Print)

(Owner's Signature)

(Owner's Mailing Address)

(City)

(State)

(Zip Code)

(Continued on page 2)

Gary Haley
Phone # (520) 648-2040

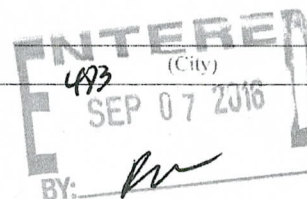

NW
RW

Connie Haley

(Owner's Name - Please Print)

X Connie L. Haley
(Owner's Signature)

PO Box 584

(Owner's Mailing Address)

Green Valley

(City)

AZ

(State)

85622

(Zip Code)

Gary Haley

(Owner's Name - Please Print)

X Gary Haley
(Owner's Signature)

PO Box 584

(Owner's Mailing Address)

Green Valley

(City)

AZ

(State)

85622

(Zip Code)

(Owner's Name - Please Print)

(Owner's Signature)

(Owner's Mailing Address)

(City)

(State)

(Zip Code)

(Owner's Name - Please Print)

(Owner's Signature)

(Owner's Mailing Address)

(City)

(State)

(Zip Code)

18 U.S.C. 1001 and 43 U.S.C. 1212 make it a crime for any person knowingly and willfully to make to any department or agency of the United States any false, fictitious or fraudulent statements or representations as to any matter within its jurisdiction.

INSTRUCTIONS

1. This certification is made under the provisions of 43 U.S.C. § 1744 and 30 U.S.C. §28-28k and the regulations thereunder (43 CFR Part 3830).
2. The claimant(s) must fill in the dates in paragraph 1 for the beginning and ending of the assessment year for which this waiver is sought.
3. The claimant(s) must fill in the date in paragraph 2 for the beginning of the assessment year for which this waiver is sought.
4. All claim and site names and BLM serial numbers must be listed for the mining claims, mill sites, and tunnel sites for which the waiver is sought.
5. All owners of the mining claims, mill sites, and tunnel sites and their addresses must be given.
6. This waiver form must be signed by all the claimants or their designated agent, in original form. If an agent is designated, a notarized designation of agent, signed by all of the claimants with proper address given, must be submitted with this waiver.
7. This form must be filed no later than September 1st for the upcoming assessment year in the BLM State Office where the mining claims or sites are recorded, or the waiver cannot be granted by the BLM. (Example: To obtain a waiver for the assessment year 2012, which begins on September 1, 2011, you must qualify for and file for a waiver no later than September 1, 2011, in the proper BLM State Office.)
8. For all mining claims which require assessment work, you must record an affidavit of labor on or before the December 30th immediately following the filing of this waiver. For all other mining claims or sites waived, you must record a notice of intent to hold on or before the December 30th immediately following the filing of this waiver.
9. Mill and tunnel sites may also be listed on this waiver and be waived from payment of the maintenance fee. A notice of intent to hold for these sites is required to be filed by the December 30th following the filing of this waiver.

RECEIVED
BLM AZ STATE OFFICE

2016 AUG 25 P 2:19

PHOENIX, ARIZONA

FOR OFFICIAL USE ONLY

Gary Haley
Phone# (520) 648-2040

UNITED STATES
DEPARTMENT OF THE INTERIOR
BUREAU OF LAND MANAGEMENT

488

MAINTENANCE FEE WAIVER CERTIFICATION

AA

418628 423064
421116 423704
421122
423063
FORM APPROVED
OMB NO. 1004-0114
Expires: October 31, 2016

SEE INSTRUCTIONS ON PAGE 2

1. This small miner waiver is filed for the assessment year beginning on September 1, ~~2014~~²⁰¹⁵ and ending on September 1, ~~2015~~²⁰¹⁶.
2. The undersigned and all related parties owned ten or fewer mining claims, mill, or tunnel sites located and maintained on Federal lands in the United States of America on September 1, 2015.
3. The undersigned have performed the assessment work required by law for each mining claim listed prior to filing this waiver and understand that by filing this form, the undersigned must file an affidavit of assessment work with the Bureau of Land Management (BLM) by the December 30th following the filing of this waiver.
4. The undersigned understand that if the assessment work obligation has not yet come due under 30 U.S.C. 28 (for those claims in their first assessment year only), a notice of intent to hold reciting this condition must be recorded by the December 30th following the filing of this waiver.
5. The undersigned understand that mill and tunnel sites may also be listed on this waiver and be waived from payment of the maintenance fee, and that a notice of intent to hold for these sites is required to be filed with the BLM by the December 30th following the filing of this waiver.
6. The undersigned understand and acknowledge that pursuant to 43 U.S.C. 1212 and 18 U.S.C. 1091, the filing or recording of a false, fictitious, or fraudulent document with the BLM may result in a fine of up to \$250,000, a prison term not to exceed five years, or both.
7. The mining claims, mill or tunnel sites for which this waiver from payment of the maintenance fees is requested are:

CLAIM OR SITE NAME	BLM RECORDATION SERIAL NUMBER
1. Peachie	418628 ✓
2. Buzzards End	421122
3. Apache Moon	421116
4. Apache Moon 2	423064
5. Honeycomb	423063
6. Skid Mark	423704
7.	
8.	
9.	
10.	

RECEIVED
BLM AZ STATE OFFICE
2015 AUG 26 P 3:00
PHOENIX, ARIZONA

The owner(s) (claimants) of the above mining claims and sites are:

Gary Haley

(Owner's Name - Please Print)

PO Box 584, Green Valley, AZ 85622

(Owner's Mailing Address)

Gary Haley

(Owner's Signature)

Green Valley

(City)

AZ

(State)

85622

(Zip Code)

Connie Haley

(Owner's Name - Please Print)

PO Box 584, Green Valley, AZ 85622

(Owner's Mailing Address)

Connie Lee Haley

(Owner's Signature)

Green Valley

(City)

AZ

(State)

85622

(Zip Code)

(Owner's Name - Please Print)

(Owner's Signature)

(Owner's Mailing Address)

(City)

(State)

(Zip Code)

(Owner's Name - Please Print)

(Owner's Signature)

(Owner's Mailing Address)

(City)

(State)

(Zip Code)

(Continued on page 2)

Gary Haley
Phone # 520-648-2040

INTEREST
SEP 03 2015
BY: *[Signature]*

NW
9/9/2015

Gary Haley

(Owner's Name - Please Print)

PO Box 584

(Owner's Mailing Address)

x Gary Haley

(Owner's Signature)

Green Valley

(City)

AZ

(State)

85622

(Zip Code)

Connie Haley

(Owner's Name - Please Print)

PO Box 584

(Owner's Mailing Address)

x Connie Lee Haley

(Owner's Signature)

Green Valley

(City)

AZ

(State)

85622

(Zip Code)

(Owner's Name - Please Print)

(Owner's Signature)

(Owner's Mailing Address)

(City)

(State)

(Zip Code)

(Owner's Name - Please Print)

(Owner's Signature)

(Owner's Mailing Address)

(City)

(State)

(Zip Code)

18 U.S.C. 1001 and 43 U.S.C. 1212 make it a crime for any person knowingly and willfully to make to any department or agency of the United States any false, fictitious or fraudulent statements or representations as to any matter within its jurisdiction.

INSTRUCTIONS

1. This certification is made under the provisions of 43 U.S.C. § 1744 and 30 U.S.C. § 28-28k and the regulations thereunder (43 CFR Part 3830).
2. The claimant(s) must fill in the dates in paragraph 1 for the beginning and ending of the assessment year for which this waiver is sought.
3. The claimant(s) must fill in the date in paragraph 2 for the beginning of the assessment year for which this waiver is sought.
4. All claim and site names and BLM serial numbers must be listed for the mining claims, mill sites, and tunnel sites for which the waiver is sought.
5. All owners of the mining claims, mill sites, and tunnel sites and their addresses must be given.
6. This waiver form must be signed by all the claimants or their designated agent, in original form. If an agent is designated, a notarized designation of agent, signed by all of the claimants with proper address given, must be submitted with this waiver.
7. This form must be filed no later than September 1st for the upcoming assessment year in the BLM State Office where the mining claims or sites are recorded, or the waiver cannot be granted by the BLM. (Example: To obtain a waiver for the assessment year 2012, which begins on September 1, 2011, you must qualify for and file for a waiver no later than September 1, 2011, in the proper BLM State Office.)
8. For all mining claims which require assessment work, you must record an affidavit of labor on or before the December 30th immediately following the filing of this waiver. For all other mining claims or sites waived, you must record a notice of intent to hold on or before the December 30th immediately following the filing of this waiver.
9. Mill and tunnel sites may also be listed on this waiver and be waived from payment of the maintenance fee. A notice of intent to hold for these sites is required to be filed by the December 30th following the filing of this waiver.

FOR OFFICIAL USE ONLY

When Recorded Return Document to:

☐ Check here is this is a change of address.

Telephone: _____

E-mail address: _____

418628
421116
421122
423063
423064
423704

AFFIDAVIT OF PERFORMANCE OF ANNUAL WORK

1. State of Arizona, County of Pima ss:

2. I (Name) Connie Haley + Gary Haley

3. Reside at (Address) PO Box 584

City Green Valley County Pima

State AZ Zip 85622 being duly sworn, depose and say that I am a citizen of the United States, more than eighteen years of age, and that all of the facts set forth in this affidavit, subject to the provisions and penalties of 18 U.S.C. 1001 pertaining to the filing of false, fictitious, or fraudulent statements with the United States, are true and correct according to the best of my knowledge, information and belief.

4. Owner's name and address (If not shown in Items 1-3 above).

Connie Haley, Gary Haley, PO BOX 584, Green Valley, AZ 85622

5. That I am personally acquainted with the mining claim(s). The work and improvements were made by and at the expense of the owner(s) of said claim(s). Said contiguous group of claims, listed on this document, are situated in the

Gila & Salt River (optional) Mining District; Pima County, Arizona.

Line No.	AMC NUMBER	CLAIM/SITE NAME	COUNTY RECORDER DATA (If available)	TWP	RNG	SEC
1	418628	Peachie	20123130204	17S	12E	003
2	421122	Buzzards End	20130590127	17S	10E	026
3	421116	Apache Moon	20130590128	17S	10E	026
4	423064	Apache Moon 2	20131420840	17S	10E	026
5	423063	Honeycomb	20131420839	17S	10E	026
6	423704	Skid Mark	20132050174	17S	10E	026

Form: MCF108
Revised July 2014
Page 1 of 2

Gary Haley

Phone # 520-648-2040

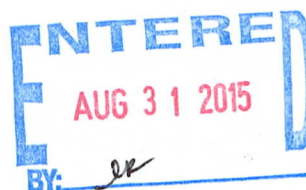

RECEIVED
BLM AZ STATE OFFICE
2015 AUG 26 P 3 01
PHOENIX, ARIZONA
BLM
Date
Stamp

7						
8						
9						
10						

6. That between the dates starting at 12 o'clock noon on September 1, 20 14 and ending at 12 o'clock noon on September 1, 20 15 at least \$ 1,100. dollars worth of work and improvements were done and performed upon said claim(s) or upon one or more of a contiguous group of claims for the benefit of all, wholly or partly outside of a contiguous group of claims for the benefit of all, not including the location work.

7. That the following persons were employed to perform the work and improvements described herein: _____

Gary Haley, Connie Haley

8. That the work and improvements performed were: Repaired roads, cut Brush, leveled dips, Fixed claim markers, filled in washed out spots.

9. Dated: 8-18-15 Signature: Gary Haley, Connie Haley

SUBSCRIBED AND SWORN TO before me, a Notary Public, this 18 day of August 20 15

By: Gary Haley & Connie Haley

Notary Public [Signature]

My Commission Expires 05/18/18 05/04/18

Bureau of Land Management
Arizona State Office
www.blm.gov/az

No. of Claims: 60 x \$10 = \$600.00
Check No.: 0965 Init. AT
Receipt No.: 3378653
For BLM Use Only

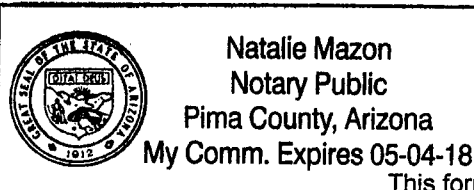

Form: MCF108
Revised July 2014
Page 2 of 2

NOTICE OF INTENTION TO HOLD MINING CLAIMS/SITES

When Recorded Return Document to:

☐ Check here if this is a change of address.Telephone:

E-mail Address:

BLM
Date
Stamp2015 AUG 26 P 3:00
PHOENIX, ARIZONARECEIVED
BLM PHOENIX OFFICE

I (We) intend to hold the claims(s) and/or site(s) listed below for the calendar year 20 15, and I (We) have filed or will file a Notice of Intent to Hold in the county where the claim (s) is located.

Reason for filing a Notice of Intent to Hold instead of an assessment work filing (check one):

- ☐ Maintenance fee was paid to maintain claim(s) during this assessment year.
☐ Mill or tunnel sites.
☐ Claim(s) was located during the current assessment year.
☒ BLM has deferred assessment work (attach copy of decision granting deferment, or pending petition for deferment including date petition was filed.)

Line No.	AMC NUMBER	CLAIM/SITE NAME	COUNTY RECORDER DATA (If available)	TWP	RNG	SEC
1	418628	Peachie	20123130204	17S	12E	003
2	421122	Buzzards End	20130590127	17S	10E	026
3	421116	Apache Moon	20130590128	17S	10E	026
4	423064	Apache Moon 2	20131420840	17S	10E	026
5	423063	Honeycomb	20131420839	17S	10E	026
6	423704	Skid Mark	20132050174	17S	10E	026
7						
8						
9						
10						

Gary Haley
Phone # 520-648-2040

NOTICE OF INTENTION TO HOLD MINING CLAIMS/SITES
page 2

BLM Date Stamp	2015 AUG 26 P 3:00 PHOENIX, ARIZONA RECEIVED BLM ARIZONA OFFICE
----------------------	--

1. State of Arizona, County of Pima
2. I (Name) Connie Haley, Gary Haley
3. Reside at (Address) 16621 Horse Hollow Trail
City Sahuarita County Pima State AZ Zip 85629 being duly sworn, depose and say that I am a citizen of the United States, more than eighteen years of age, that all of the facts set forth in this notice, subject to the provisions and penalties of 18 U.S.C. 1001 pertaining to the filing of false, fictitious, or fraudulent statements with the United States, are true and correct according to the best of my knowledge, information and belief.
4. Owner's name and address (If not shown in Items 1-3 above). Connie Haley, Gary Haley

5. Dated: _____ Signature: Connie L. Haley, Gary Haley

Bureau of Land Management
Arizona State Office
www.blm.gov/az

No. of Claims: _____ x \$10 = _____
Check No: _____ Init. _____
Receipt No.: _____
For BLM Use Only

Form: MCF110
Revised July 2014
Page 2 of 2

Connie & Gary Haley
PO Box 584
Green Valley, AZ 85622

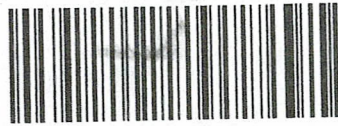

7015 0640 0006 5034 0665



1000



85004

U.S. POSTAGE
PAID
GREEN VALLEY, AZ
85614
AUG 20, 15
AMOUNT
\$4.65
R2304M112169-1

RECEIVED
BLM STATE OFFICE
2015 AUG 26 P 3:00
PHOENIX, ARIZONA

**UNITED STATES
DEPARTMENT OF INTERIOR**
Bureau of Land Management
Arizona State Office
One North Central Avenue, Suite 800
Phoenix, Arizona 85004-4427

United States Department of the Interior
Bureau of Land Management
 LANDS/RECREATION & PLANNING
 ONE N CENTRAL AVE
 PHOENIX, AZ 85004 -2203
 Phone: 602-417-9200

Receipt

No: 3378653

Transaction #: 3476906	
Date of Transaction: 08/27/2015	
CUSTOMER:	
	GARY L HALEY PO BOX 584 GREEN VALLEY, AZ 85622-0584 US

LINE #	QTY	DESCRIPTION	REMARKS	UNIT PRICE	TOTAL
1	1.00	LOCATABLE MINERALS / MINING CLAIMS-NOT NEW-UNADJUD, ONE AUTH NO. ONLY / MINING CLAIM MONEY RECEIVED CASES: AMC418628/\$60.00	WAIVER - 6 2016 / POL - 6 2015 / NOI - 6 2015	- n/a -	60.00
TOTAL:					\$60.00

PAYMENT INFORMATION			
1	AMOUNT:	60.00	POSTMARKED:
	TYPE:	CHECK	RECEIVED:
	CHECK NO:	0965	
	NAME:	HALEY, GARY L PO BOX 584 GREEN VALLEY AZ 85622-0584 US	

REMARKS

This receipt was generated by the automated BLM Collections and Billing System and is a paper representation of a portion of the official electronic record contained therein.

ENTERED
AUG 31 2015
 BY: *jr*

8/27/2015

UNITED STATES
DEPARTMENT OF THE INTERIOR
BUREAU OF LAND MANAGEMENT

MAINTENANCE FEE WAIVER CERTIFICATION

SEE INSTRUCTIONS ON PAGE 2

FORM APPROVED
OMB NO. 1004-0114
Expires: October 31, 2016

1. This small miner waiver is filed for the assessment year beginning on September 1, ~~2013~~ ²⁰¹⁴ and ending on September 1, ~~2014~~ ²⁰¹⁵.
2. The undersigned and all related parties owned ten or fewer mining claims, mill, or tunnel sites located and maintained on Federal lands in the United States of America on September 1, ~~2014~~ ²⁰¹⁴.
3. The undersigned have performed the assessment work required by law for each mining claim listed prior to filing this waiver and understand that by filing this form, the undersigned must file an affidavit of assessment work with the Bureau of Land Management (BLM) by the December 30th following the filing of this waiver.
4. The undersigned understand that if the assessment work obligation has not yet come due under 30 U.S.C. 28 (for those claims in their first assessment year only), a notice of intent to hold reciting this condition must be recorded by the December 30th following the filing of this waiver.
5. The undersigned understand that mill and tunnel sites may also be listed on this waiver and be waived from payment of the maintenance fee, and that a notice of intent to hold for these sites is required to be filed with the BLM by the December 30th following the filing of this waiver.
6. The undersigned understand and acknowledge that pursuant to 43 U.S.C. 1212 and 18 U.S.C. 1001, the filing or recording of a false, fictitious, or fraudulent document with the BLM may result in a fine of up to \$250,000, a prison term not to exceed five years, or both.
7. The mining claims, mill or tunnel sites for which this waiver from payment of the maintenance fees is requested are:

CLAIM OR SITE NAME	BLM RECORDATION SERIAL NUMBER
1. Peachie	418628
2. Buzzards End	421122
3. Apache Moon	421116
4. Apache Moon 2	423064
5. Honeycomb	423063
6. Skid Mark	423704
7.	
8.	
9.	
10.	

RECEIVED
BLM AZ STATE OFFICE
2014 AUG 27 PM 2:21
PHOENIX, ARIZONA

The owner(s) (claimants) of the above mining claims and sites are:

Gary Haley

(Owner's Name - Please Print)

PO Box 584, Green Valley, AZ 85622

(Owner's Mailing Address)

Gary Haley

(Owner's Signature)

Green Valley

(City)

AZ

(State)

85622

(Zip Code)

Connie Haley

(Owner's Name - Please Print)

PO Box 584, Green Valley, AZ 85622

(Owner's Mailing Address)

Connie L. Haley

(Owner's Signature)

Green Valley

(City)

AZ

(State)

85622

(Zip Code)

(Owner's Name - Please Print)

(Owner's Signature)

(Owner's Mailing Address)

(City)

(State)

(Zip Code)

(Owner's Name - Please Print)

(Owner's Signature)

(Owner's Mailing Address)

(City)

(State)

(Zip Code)

(Continued on page 2)

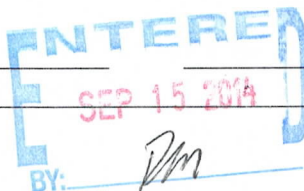

NW
9/23/2014
km

(Owner's Name - Please Print)

(Owner's Signature)

(Owner's Mailing Address)

(City)

(State)

(Zip Code)

(Owner's Name - Please Print)

(Owner's Signature)

(Owner's Mailing Address)

(City)

(State)

(Zip Code)

(Owner's Name - Please Print)

(Owner's Signature)

(Owner's Mailing Address)

(City)

(State)

(Zip Code)

(Owner's Name - Please Print)

(Owner's Signature)

(Owner's Mailing Address)

(City)

(State)

(Zip Code)

18 U.S.C. 1001 and 43 U.S.C. 1212 make it a crime for any person knowingly and willfully to make to any department or agency of the United States any false, fictitious or fraudulent statements or representations as to any matter within its jurisdiction.

INSTRUCTIONS

1. This certification is made under the provisions of 43 U.S.C. § 1744 and 30 U.S.C. §28-28k and the regulations thereunder (43 CFR Part 3830).
2. The claimant(s) must fill in the dates in paragraph 1 for the beginning and ending of the assessment year for which this waiver is sought.
3. The claimant(s) must fill in the date in paragraph 2 for the beginning of the assessment year for which this waiver is sought.
4. All claim and site names and BLM serial numbers must be listed for the mining claims, mill sites, and tunnel sites for which the waiver is sought.
5. All owners of the mining claims, mill sites, and tunnel sites and their addresses must be given.
6. This waiver form must be signed by all the claimants or their designated agent, in original form. If an agent is designated, a notarized designation of agent, signed by all of the claimants with proper address given, must be submitted with this waiver.
7. This form must be filed no later than September 1st for the upcoming assessment year in the BLM State Office where the mining claims or sites are recorded, or the waiver cannot be granted by the BLM. (Example: To obtain a waiver for the assessment year 2012, which begins on September 1, 2011, you must qualify for and file for a waiver no later than September 1, 2011, in the proper BLM State Office.)
8. For all mining claims which require assessment work, you must record an affidavit of labor on or before the December 30th immediately following the filing of this waiver. For all other mining claims or sites waived, you must record a notice of intent to hold on or before the December 30th immediately following the filing of this waiver.
9. Mill and tunnel sites may also be listed on this waiver and be waived from payment of the maintenance fee. A notice of intent to hold for these sites is required to be filed by the December 30th following the filing of this waiver.

RECEIVED
BLM AZ STATE OFFICE
JUN 27 P 2:21
PHOENIX, ARIZONA

FOR OFFICIAL USE ONLY

NOTICE OF INTENTION TO HOLD MINING CLAIMS/SITES
page 2

BLM
Date
Stamp

2014 AUG 27 P 2:21

RECEIVED
BLM AZ STATE OFFICE

1. State of Arizona, County of Pima

2. I (Name) Connie Haley & Gary Haley

3. Reside at (Address) 16621 Horse Hollow Trail

City Sahuarita County Pima State AZ Zip 85629 being duly sworn, depose and say that I am a citizen of the United States, more than eighteen years of age, that all of the facts set forth in this notice, subject to the provisions and penalties of 18 U.S.C. 1001 pertaining to the filing of false, fictitious, or fraudulent statements with the United States, are true and correct according to the best of my knowledge, information and belief.

4. Owner's name and address (If not shown in Items 1-3 above).

5. Dated: Aug 26 2014 Signature: Gary Haley Connie Lee Haley

Bureau of Land Management
Arizona State Office
www.az.blm.gov

No. of Claims: 6 x \$10 = \$60
Check No: 801 Init. CH
Receipt No.: 3115369
For BLM Use Only

Form: MCF110
Revised Jan. 2006
Page 2 of 2

UNITED STATES
DEPARTMENT OF THE INTERIOR
BUREAU OF LAND MANAGEMENT

AFFIDAVIT OF ANNUAL ASSESSMENT WORK

418628
FORM APPROVED 421122
OMB NO.: 1004-0114 421116
Expires: October 31, 2016 423063
423064
423704

WHEN RECORDED, MAIL DOCUMENT TO:

NAME: Gary & Connie Haley

ADDRESS: PO Box 584

CITY, STATE, ZIP: Green Valley, AZ 85622

FOR COUNTY RECORDER'S USE

No. of Claims 6
x \$10/claim
Total due BLM \$ 60.

TO ALL WHOM IT MAY CONCERN:

1. The undersigned certifies that at least \$100 per claim was expended for development, labor and improvements, or equivalent value added, as the annual assessment work for the assessment year ending September 1, 2014 for the following contiguous unpatented mining claim(s), located in the County of Pima, in the State of Arizona.

BLM Serial No.	Name of Claim	Tp	Rg	Sec	Mer	County Recordation Book and Page No.	Date
418628	Peachie	17 S	12 E	003	Gila & S	20123130204 page 3	11/08/2012
421122	Buzzards End	17 S	10 E	026	Gila & S	20130590127 page 2	2/28/2013
421116	Apache Moon	17 S	10 E	026	Gila & S	20130590128 page 2	2/28/2013
423064	Apache Moon 2	17 S	10 E	026	Gila & S	20131420840 page 3	5/22/2013
423063	Honeycomb	17 S	10 E	026	Gila & S	20131420839 page 3	5/22/2013
423704	Skid Mark	17 S	10 E	026	Gila & S	20132050174 page 2	7/24/2013

(Continued on page 2)

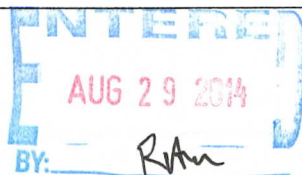

RECEIPT # 3115369

RECEIVED
BLM AZ STATE OFFICE
2014 AUG 27 P 2:21
PHOENIX, ARIZONA

2. Type of labor and improvements (specify what was done and give the total value for that labor and improvement to show at least \$100 for each claim). If a geological, geochemical, or geophysical survey was performed, as per 30 U.S.C. 28-1, reference the title of the report of survey, give cost and date of the survey and report, and indicate it was filed with the County Recorder:

Description of Work Performed	Value of Work Performed	Date Work Was Performed
Roadwork (potholes filled), trash cleanup.	\$200.	October 7, 2013
Leveled road, jackhammer work, brush/ rock removal, etc.	\$600.	January 4, 2014
Fixed washed out road, remove roadblock & cut brush.	\$250.	March 16, 2014
Removed brush from blocking the roads.	\$100.	April 8, 2014
Backfilled holes on claim roads.	\$250.	May 5, 2014

3. Name and mailing address of each person who performed the labor and improvements:

Name (please print)

Gary Haley

Connie Haley

Current Mailing Address (please print)

PO Box 584, Green Valley, AZ 85622

PO Box 584, Green Valley, AZ 85622

4. Name and mailing address of each person who holds and claims the subject mining claim(s) for the valuable minerals contained therein. Be sure to indicate if there is a change of address:

Name (please print)

Gary Haley

Connie L Haley

Current Mailing Address (please print)

PO Box 584, Green Valley, AZ 85622

PO Box 584, Green Valley, AZ 85622

5. The undersigned testifies that on the date of August 26, 2014, all monuments required by law were erected upon the subject claim(s), and all notices required by law were posted on the subject claim(s) or copies thereof were in place, and at said date, each corner monument bore or contained

RECEIVED
BLM AZ STATE OFFICE
2014 AUG 27 11:21 AM
PHOENIX, ARIZONA

markings sufficient to appropriately designate the corner of the claim to which it pertains and the name of the claim(s).

I hereby certify under penalty of perjury under the laws of the State of Arizona that the foregoing statements are true and correct:

Gary Haly Date: 8-25-2014
(Signature of person responsible for above statement)

Title 18 U.S.C. 1001 and 43 U.S.C. 1212 make it a crime for any person knowingly and willfully to make to any department or agency of the United States any false, fictitious or fraudulent statements or representations as to any matter within its jurisdiction.

Notary Block

SUBSCRIBED AND SWORN TO before me, this 25 day of August 2014

By: Victoria Ochoa
(Signature of Affiant)

Title: Notary Public

My Commission Expires: 9/30/2014

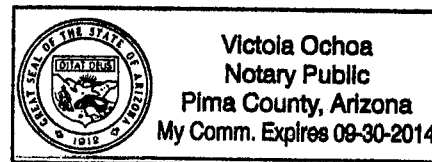

INSTRUCTIONS

1. This is an optional form that may be used to satisfy the requirements for the Bureau of Land Management (BLM) under the provisions of 43 U.S.C. §1744 and 30 U.S.C. §28-28d and the regulations thereunder (43 CFR part 3835). Since local and State laws may vary, you should contact your local and State agencies where the claims are located to ensure all applicable laws and requirements are satisfied.
2. The claimant(s) must fill in the date in paragraph 1 for the applicable assessment year and the county and state where the claims are located.
3. All claim names, BLM serial numbers, legal descriptions, and original county recording information must be listed for the claims pertaining to this assessment notice.
4. The claimant(s) must complete paragraph 2 listing all labor or improvements which was performed on or did benefit the subject mining claims. The value and date of the labor or improvements must also be listed. The total amount of labor or improvements can be listed, but the total expenditure must equal at least \$100 for each claim.
5. The names and current mailing addresses of the person(s) performing the labor shall be listed in paragraph 3.
6. The name and current mailing address of each owner (claimant) of the claims shall be listed in paragraph 4. The mailing address shall be the owner's address and not the address of an agent or anyone representing the claimant. Be sure to note if there has been a change of address.
7. Paragraph 5 shall be completed to show the date it was verified that all monuments required by law were properly erected, all notices were posted, and that corners were appropriately designated for all claims listed.
8. An exact legible reproduction or duplicate (other than microfilm or other electronic media) of this affidavit or another type of affidavit of assessment work that you file or will file in the county where each claim is located must be filed with the BLM on or before December 30 of the calendar year in which the assessment year ends. For mill or tunnel sites, a separate notice of intent to hold must be filed with the BLM on or before December 30. Requirements for filing a notice of intent to hold can be found at 43 CFR 3835.33.
9. A processing fee of \$10 for each claim listed must be remitted to the BLM along with this or any other affidavit of assessment work.

RECEIVED
BLM AZ STATE OFFICE
TUCSON, ARIZONA
AUG 27 P 2:11

Connie & Gary Haley
PO Box 584
Green Valley, AZ 85622

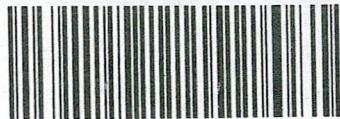

7012 2920 0000 3116 0080



1000

85004

U.S. POSTAGE
PAID
GREEN VALLEY, AZ
AUG 25, 14
AMOUNT

\$4.49

00075310-05

BLM
One North Central Ave. Suite 800
Phoenix AZ 85004-4427

RECEIVED
BLM AZ STATE OFFICE
2014 AUG 27 P 2:21
PHOENIX, ARIZONA

NOTICE OF INTENTION TO HOLD MINING CLAIMS/SITES

When Recorded Return Document to:

Gary & Connie Haley
P.O. Box 584
Green Valley, AZ 85622

BLM
Date
Stamp

RECEIVED
BLM AZ DIST OFFICE
2014 NOV 17 P 3:13
PHOENIX, ARIZONA

☐ Check here if this is a change of address.

Telephone: 520 648-2040

E-mail Address adamsplace773@peoplepc.com

I (We) intend to hold the claims(s) and/or site(s) listed below for the calendar year 2014, and I (We) have filed or will file a Notice of Intent to Hold in the county where the claim (s) is located.

Reason for filing a Notice of Intent to Hold instead of an assessment work filing (check one):

- ☒ Maintenance fee was paid to maintain claim(s) during this assessment year.
☐ Mill or tunnel sites.
☐ Claim(s) was located during the current assessment year.
☐ BLM has deferred assessment work (attach copy of decision granting deferment, or pending petition for deferment including date petition was filed.)

Line No.	AMC NUMBER	CLAIM/SITE NAME	COUNTY RECORDER DATA (If available)	TWP	RNG	SEC
1	418628	Peachie	20123130204 Pg 3	17S	12E	003
2	421122	Buzzards End	20130590127 Pg 2	17S	10E	026
3	421116	Apache Moon	20130590128 Pg 2	17S	10E	026
4	423064	Apache Moon 2	20131420840 Pg 3	17S	10E	026
5	423063	Honeycomb	20131420839 Pg 3	17S	10E	026
6	423704	Skid Mark	20132050174 Pg 2	17S	10E	026
7						
8						
9						
10						

Form: MCF110

Revised Jan. 2006

Page 1 of 2

ENTERED
DEC 03 2014
BY: RM

SENT BOTH NOI &
POL. NOI REQUIRED.

NOTICE OF INTENTION TO HOLD MINING CLAIMS/SITES
page 2

RECEIVED PIMA STATE OFFICE	2014 NOV 17 P 3:13 PHOENIX, ARIZONA	BLM Date Stamp
-------------------------------	--	----------------------

1. State of Arizona, County of Pima

2. I (Name) Gary & Connie Haley

3. Reside at (Address) PO Box 584

City Green Valley County Pima State AZ Zip 85622 being duly sworn, depose and say that I am a citizen of the United States, more than eighteen years of age, that all of the facts set forth in this notice, subject to the provisions and penalties of 18 U.S.C. 1001 pertaining to the filing of false, fictitious, or fraudulent statements with the United States, are true and correct according to the best of my knowledge, information and belief.

4. Owner's name and address (If not shown in Items 1-3 above). _____

5. Dated: 11-10-14 Signature: Gary Haley - Connie Lee Haley

Bureau of Land Management
Arizona State Office
www.az.blm.gov

No. of Claims: _____ x \$10 = _____

Check No: _____ Init. _____

Receipt No.: 3115369

For BLM Use Only

Paid

Form: MCF110
Revised Jan. 2006
Page 2 of 2

Connie & Gary Haley
PO Box 584
Green Valley, AZ 85622

RECEIVED
PHX AZ STATE OFFICE

2014 NOV 17 P 3:06 **BLM**

PHOENIX, ARIZONA **Arizona State office**
One North Central Ave. Suite 800
Phoenix, AZ 85004-4427
ATTN: Re'Ann Myers

PHOENIX AZ 850

15 NOV 2014 PM 6 L



85004442700



Connie & Gary Haley
PO Box 584
Green Valley, AZ 85622

PHOENIX AZ 852

15 NOV 2014 PM 6 L

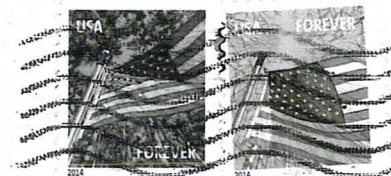

RECEIVED
BLM AZ STATE OFFICE

2014 NOV 17 P 3:06 **BLM**

PHOENIX, ARIZONA **Arizona State office**
One North Central Ave. suite 800
Phoenix, AZ 85004-4427
ATTN: Re'Ann Myers

85004442700

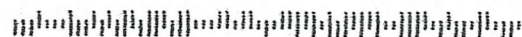

United States Department of the Interior
Bureau of Land Management
 LANDS/RECREATION & PLANNING
 ONE N CENTRAL AVE
 PHOENIX, AZ 85004 -2203
 Phone: 602-417-9200

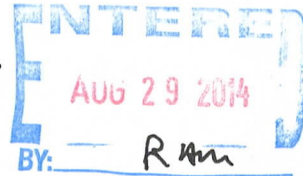

Receipt

No:

3115369

Transaction #: 3207111	
Date of Transaction: 08/28/2014	
CUSTOMER:	
	GARY L HALEY PO BOX 584 GREEN VALLEY, AZ 85622-0584 US

LINE #	QTY	DESCRIPTION	REMARKS	UNIT PRICE	TOTAL
1	1.00	LOCATABLE MINERALS / MINING CLAIMS-NOT NEW-UNADJUD, ONE AUTH NO. ONLY / MINING CLAIM MONEY RECEIVED CASES: AMC418628/\$60.00	MAINT FEE WAIVER (6) 2015 / POL (6) 2014 / NOI (2ND PAGE ONLY)	- n/a -	60.00
TOTAL:					\$60.00

PAYMENT INFORMATION			
1	AMOUNT:	60.00	POSTMARKED: 08/25/2014
	TYPE:	CHECK	RECEIVED: 08/27/2014
	CHECK NO:	801	
	NAME:	HALEY, GARY L PO BOX 584 GREEN VALLEY AZ 85622-0584 US	

REMARKS

This receipt was generated by the automated BLM Collections and Billing System and is a paper representation of a portion of the official electronic record contained therein.

UNITED STATES
DEPARTMENT OF THE INTERIOR
BUREAU OF LAND MANAGEMENT
**MAINTENANCE FEE PAYMENT FORM FOR
LODE CLAIMS, MILL SITES, AND TUNNEL SITES**

AMC 418628
AMC 421122
AMC 421116
AMC 423064
AMC 423063
AMC 423704

Remitter Name: Connie L. Haley - Mary Haley
Mailing Address: PO Box 584
City, State, Zip: Green Valley, AZ 85622

☐ Check here if this is a change of address.

FOR COUNTY RECORDER'S USE

No. of claims/sites 6
x \$140 per claim/site
Total due BLM \$ 840.00

- The maintenance fee may be paid by cash, check, money order, Bureau of Land Management (BLM) Declining Deposit Account, or credit card (VISA, American Express, Discover, or MasterCard). Payments must be remitted to the BLM State Office where your claim or site is recorded and received on or before September 1. If the payment is mailed, the envelope must be postmarked by a bona fide delivery service on or before September 1 and received at the proper BLM State Office within 15 calendar days after the due date. Payments may also be made by telephone using a credit card. A complete listing of BLM State Offices with their addresses and phone numbers can be found at <http://www.blm.gov>.
- The maintenance fee for the following claim(s)/site(s) applies to the assessment year 2014.

CLAIM/SITE NAME	BLM SERIAL NO.
<u>Peachie</u>	<u>AMC 418628</u>
<u>Buzzards End</u>	<u>AMC 421122</u>
<u>Apache Moon</u>	<u>AMC 421116</u>
* <u>Apache Moon 2</u>	<u>AMC 423064</u>
<u>Honeycomb</u>	<u>AMC 423063</u>
<u>Skid Mark</u>	<u>AMC 423704</u>

Use a separate sheet for additional claim/site names, serial numbers, and claimant names and addresses.

(Continued on page 2)

Receipt # 12865545
CH

ENTERED
SEP 03 2013
BY: TS

RECEIVED
BLM AZ STATE OFFICE
2013 AUG 26 P 12:57
PHOENIX, ARIZONA

United States Department of the Interior
Bureau of Land Management
 LANDS/RECREATION & PLANNING
 ONE N CENTRAL AVE
 PHOENIX, AZ 85004 -2203
 Phone: 602-417-9200

Receipt

No: 2865545

Transaction #: 2951466	
Date of Transaction: 08/27/2013	
CUSTOMER:	
	CONNIE HALEY PO BOX 584 GREEN VALLEY, AZ 85622 US

LINE #	QTY	DESCRIPTION	REMARKS	UNIT PRICE	TOTAL
1	1.00	LOCATABLE MINERALS / MINING CLAIMS- NOT NEW-UNADJUD, ONE AUTH NO. ONLY / MINING CLAIM MONEY RECEIVED CASES: AMC418628/\$840.00	MAINT FEE PYMNT (6) 2014	- n/a -	840.00
TOTAL:					\$840.00

PAYMENT INFORMATION			
1	AMOUNT:	840.00	POSTMARKED: 08/24/2013
	TYPE:	CHECK	RECEIVED: 08/26/2013
	CHECK NO:	644	
	NAME:	HALEY, GARY L PO BOX 584 GREEN VALLEY AZ 85622 US	

REMARKS

This receipt was generated by the automated BLM Collections and Billing System and is a paper representation of a portion of the official electronic record contained therein.

NOTICE!!

These documents have been scanned!

Do not place un-scanned documents beneath this notice!

Do not remove this notice from this file!

GPO Jacket No. 560-102
Print Order 61540
Rise Business Services, LLC
Job=AZ15 5/13/2019



Box Number= AZ15043



Claim Begin-End: AMC418628-AMC418628

6 Location Notices-Amendments and Supporting Documents



AZ15043-1

AMC418628-AMC420131

CLAIM STATUS REPORT

DATA

ENTERED NOV 29 2012 *pb*

MTP Checked by

NOV 29 2012 *pb*

GEO Checked by

NOV 29 2012 *pb*

LEAD SERIAL NUMBER

AMC

418628

thru

AMC

OF CLAIMS & TYPE

1 LODE

PLACER

ASSOCIATION PLACER

MILL SITE

TUNNEL SITE

CHARGES

Location Fee @ \$34 = \$ 34.00

Processing Fee @ \$15 = \$ 15.00

Maintenance Fee @ \$140 = \$ 140.00

Overage (+) \$

Shortage (-) \$

Other Fees \$

TOTAL \$ 189.00

TOTAL CLAIM ACREAGE?

OF LOCATORS?

DOCUMENTS RECEIVED VIA -

Over-the-Counter []

Mail [X]

TIMELY FILED?

Yes [X] No []

LEGAL DESCRIPTION -

T 17S R 12E

SEC 3

T R

SEC

T R

SEC

T R

SEC

BLM [] FOREST SERVICE []

SUBJ TO PL 359: Yes [] No []

WILDERNESS AREA: No [] Yes []

SPLIT ESTATE -

N/A [] SX [] PX [] SRHA [] OTHER []

Proper Notice Filed if Located on SHRA Lands? N/A [] Yes [] No []

RECONVEYED MINERALS ON BLM LANDS REQUIRE OPENING ORDERS FROM 1944 TO 1993 -

Open to Entry on: N/A []

COMMENTS/STATUS -

VOID [] PARTIALLY VOID [] PVT MINERALS [] WITHDRAWN LANDS []

OTHER []

Claimant acknowledges that portions of the following claims(s) site(s) may be void or voidable.

Printed Name of Claimant

Signature of Claimant

***** FINAL ADJUDICATION *****

DATE 6.5.13

INITIALS RE

ANC418628

$$\frac{30}{37} = \frac{49}{49}$$

$$\begin{array}{r} 1470 \\ 37 \overline{) 1470} \\ \underline{39} \end{array}$$

LOCATION NOTICE FOR LODE MINING CLAIM

NOTICE IS HEREBY GIVEN that the Peachie

_____ lode mining claim has been located

by Connie Haley + Gary Haley whose current mailing
address is PO Box 584 Green Valley, Arizona
85622

BLM
Date
Stamp

PHOENIX, ARIZONA

2012 OCT 31 P 12:14

RECEIVED
BLM ARIZONA OFFICE

The general course of this claim is South to North and it is situated in Pima
County, Arizona. This claim is 1500 feet in length and 600 feet in width. This claim runs
from the location monument on which this location notice is posted approximately 1500 feet in a
Northern direction to the North end line and 0 feet in a South direction to the
South end line. This claim is marked by six monuments, one at each corner and one at the center of each
end line of the claim.

The location monument on which this notice is posted is situated within Section 003, Township 17
S, Range 12 E, Gila Salt River Base and Meridian, Arizona and this claim encompasses portions
of the following quarter section (s), section (s), Township (s) and Range (s) NE 1/4 of Section 003,
Township 17 South, Range 12 East.

Gila Salt River Base and Meridian, Arizona.

The locality of this claim with reference to some natural object or permanent monument and additional information
(if any) concerning its locality are as follows: Location Marker is 1.4 miles N.W. of
Helmet Peak and 0.2 miles N.E. White Hill, Longitude + Latitude of
Location Marker (ctr line A-B) is N. 31° 58.737' - W 111° 06.049' (+/-) N 31° 58.988' W 111° 06.053'

DATED AND POSTED on the ground this 08 day of October, 20 12.

LOCATOR (s) Connie L. Haley + Gary Haley

Form MCF100
Revised July 2005

AMC418628

MINING CLAIM MAP

Lode (X) Placer ()

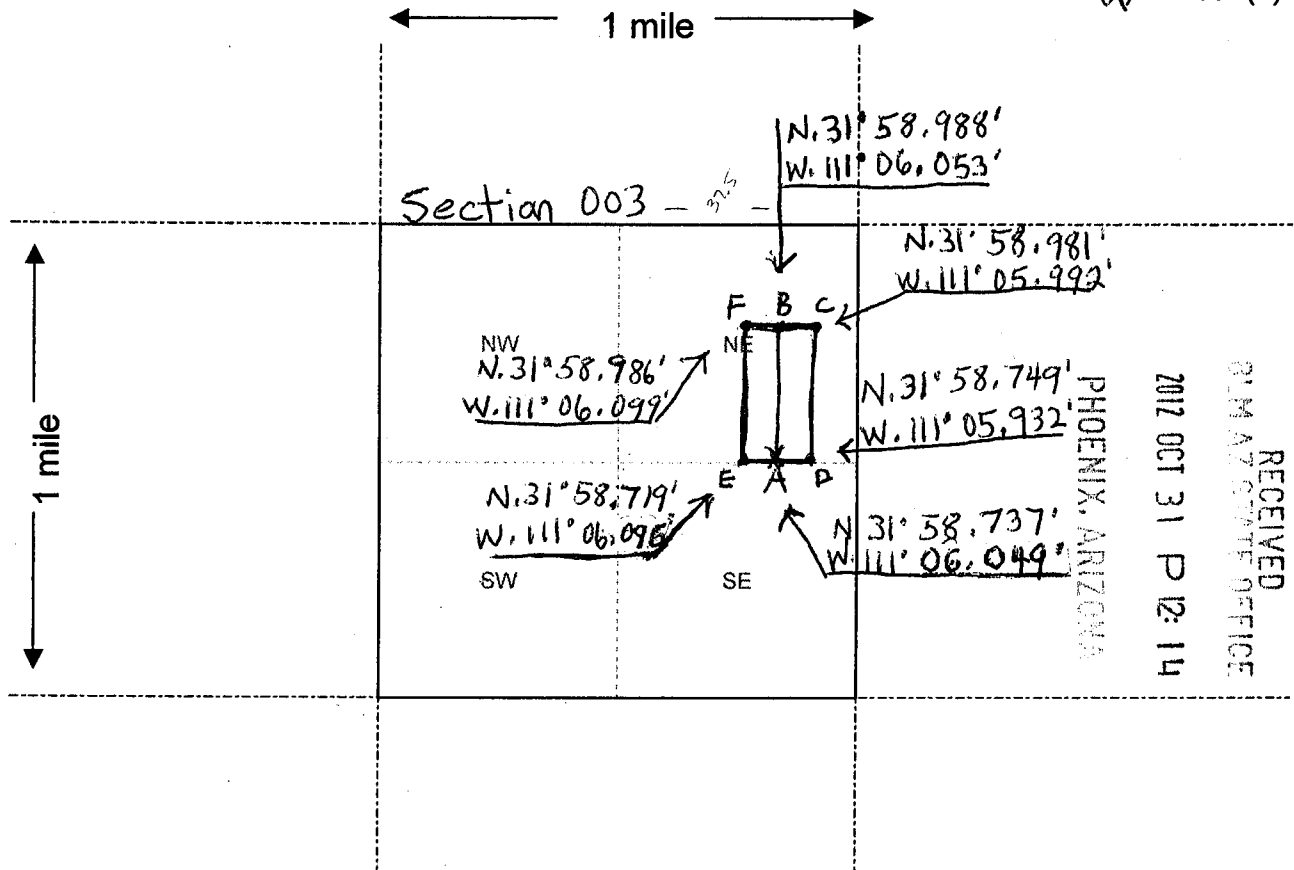

Scale : 1" = 2000 feet



1. The above map depicts the Pearchie mining claim, which is located in Section (s) 003, Township 17 S, Range 12 E, Gila and Salt River Base and Meridian, _____ County, Arizona.

2. The type of corner and location monuments used are as follows: Wooden stakes with stones
Location Notice attached inside plastic bottle on monument Post.

3. The bearings and distances in degrees and feet between claim corners are as depicted on the map.

Form MCF100a
Revised July 2005

This form is available from the Arizona Department of Mines & Mineral Resources and may be reproduced.

AMC418628

RUN TIME: 08:15 AM

UNITED STATES DEPARTMENT OF THE INTERIOR
BUREAU OF LAND MANAGEMENT

RUN DATE: 11/29/2012

Input Parameters for CR Geographic Report with Customer

Total Rows Returned: 13

System Id = CR

Admin State = AZ

Geo State = AZ

Casetype begins with

Casetype Txt =

Case Disp Txt = AUTHORIZED, CANCELLED, EXPIRED, PENDING, REJECTED, RELINQUISHED, WITHDRAWN

Mer Twp Rng =

Section =

Mtrs = 14 0170S 0120E 003, 14 0170S 0120E 999

NO WARRANTY IS MADE BY BLM FOR USE OF THE DATA
FOR PURPOSES NOT INTENDED BY BLM

UNITED STATES DEPARTMENT OF INTERIOR
BUREAU OF LAND MANAGEMENT
GEOGRAPHIC CROSS REFERENCE
Sorted by Meridian Township Range

Admin State: AZ

Geo State: AZ

Mer Twp Rng: 14 0170S 0120E

Serial Number	Casetype	Disposition	Actn Code	Actn Txt	Date	Action Remarks
AZA 024718	285003	AUTHORIZED	307	ROW GRANTED-ISSUED	04/19/1991	30 YRS
TRICO ELECTRIC COOP INC		BOX 930		MARANA		AZ 85653
						Total Acres = 0.017
						100.00000 HOLDER

Section	Sur Nr	Sur Suffix	Sur Type	Aliquot Part
003			LOTS	1;

Serial Number	Casetype	Disposition	Actn Code	Actn Txt	Date	Action Remarks
AZA 03271801	281009	AUTHORIZED	018	TRESPASS RESOLVED	11/01/2006	
BLOWERS TIMOTHY		13950 N SEIFERT ESTATES DR		TUCSON		AZ 85742
						Total Acres = 15.1
						100.00000 PARTY-IN-INTEREST

Section	Sur Nr	Sur Suffix	Sur Type	Aliquot Part
003			LOTS	1,2,7,9,13;

Serial Number	Casetype	Disposition	Actn Code	Actn Txt	Date	Action Remarks
AZA 035368	179201	PENDING	387	CASE ESTABLISHED	07/01/2009	
BLM AZ SO		1 N CENTRAL AVE #800		PHOENIX		AZ 85004
						Total Acres = 28000
						100.00000 HOLDER/BILLEE

Section	Sur Nr	Sur Suffix	Sur Type	Aliquot Part
003			ALIQ	E2NE,SESW,SWSE;

Serial Number	Casetype	Disposition	Actn Code	Actn Txt	Date	Action Remarks
AZAR 0035840	286202	AUTHORIZED	307	ROW GRANTED-ISSUED	09/11/1968	50 YRS
CENTURYLINK		135 W ORION ST		TEMPE		AZ 852832851
QWEST CORP		700 W MINERAL AVE NM-M2931		LITTLETON		CO 801204511
QWEST CORP		135 W ORION ST FL 1		TEMPE		AZ 852832851
						Total Acres = 2.81
						0.00000 DOING BUSINESS AS(DBA)
						0.00000 BILLEE
						100.00000 HOLDER

Section	Sur Nr	Sur Suffix	Sur Type	Aliquot Part

NO WARRANTY IS MADE BY BLM FOR USE OF THE DATA
FOR PURPOSES NOT INTENDED BY BLM

RUNTIME: 08:15 AM

UNITED STATES DEPARTMENT OF INTERIOR
BUREAU OF LAND MANAGEMENT
GEOGRAPHIC CROSS REFERENCE
Sorted by Meridian Township Range

RUNDATE: 11/29/2012
Page 2 of 2

003

LOTS

1,5;

NO WARRANTY IS MADE BY BLM FOR USE OF THE DATA
FOR PURPOSES NOT INTENDED BY BLM

PIMA COUNTY

MTP
SUPPL SECS 3,9,10

FOR ORDERS AFFECTING DISPOSAL OR USE OF
UNIDENTIFIED LANDS WITHDRAWN FOR CLASSIFICATION,
MINERALS, WATER AND/OR OTHER PUBLIC PURPOSES,
REFER TO INDEX OF MISCELLANEOUS DOCUMENTS.

DIST NO 4

MDS 622 NE
623 NW

AZA 32175 R/W
Sec 10 : SE1/4

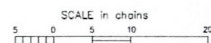

WARNING STATEMENT
This plot is the Bureau's Record of Title, and should be used only as a graphic display of the township survey data. Records hereon do not reflect title changes which may have been effected by lateral movements of rivers or other bodies of water. Refer to the coastal surveys for official survey information.

CURRENT TO	MM	GSR Mer
11-23-2004	PV	T 17 S
		R 12 E

NO 2

GSR Mer
T 17 S
R 12 E

Drew claim proportionately to the map the claimants' supplied

RS 6.5.13

PIMA COUNTY

INDEX TO SEGREGATED TRACTS

[illegible]

DIST NO 4

MDS 622 NE

623 NW

624 SE

AZA 32175 R/W

Sec 10 : SE1/4

Sec 11 : Lots 5-7, 13, 14



SCALE in chains

WARNING STATEMENT
This plot is the Bureau's Record of Title, and should be used only as a graphic display of the township survey data. Records hereon do not reflect title changes which may have been effected by lateral movements of rivers or other bodies of water. Refer to the cadastral surveys for official survey information.

CURRENT TO	GS	GSR Mer
5-18-2005	PV	T 17 S
		R 12 E